



USER MANUAL



Product description

Note: Do not plug the power cord into the pole, otherwise the power cord will break!

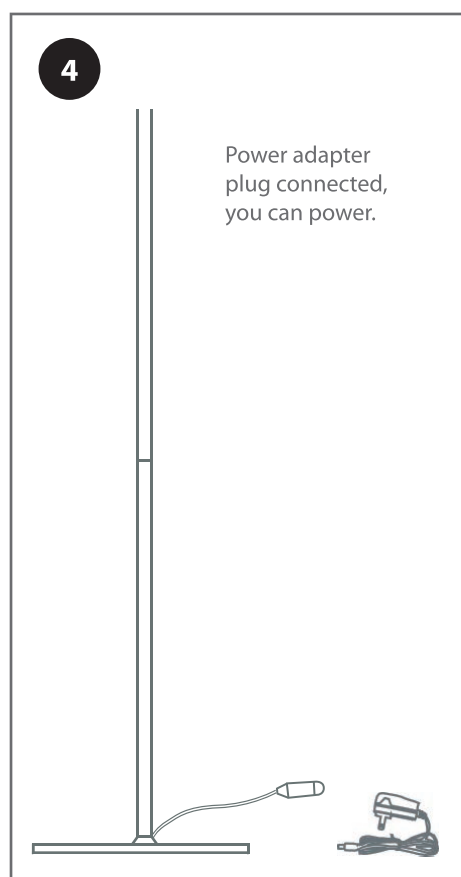
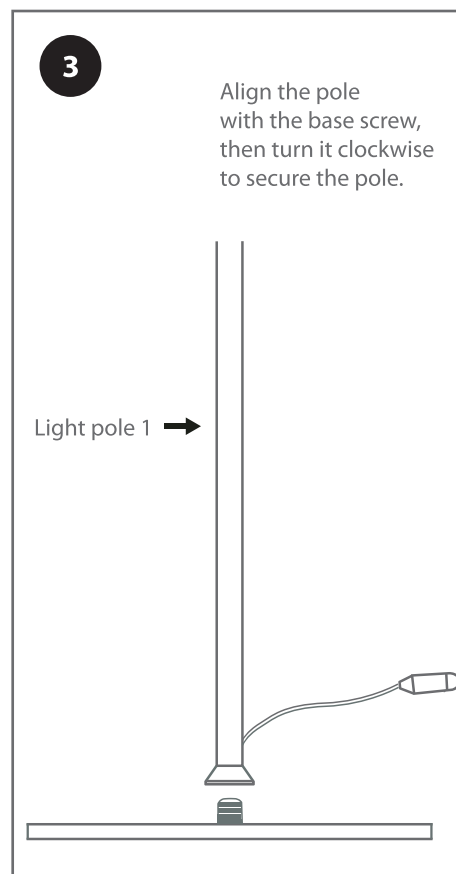
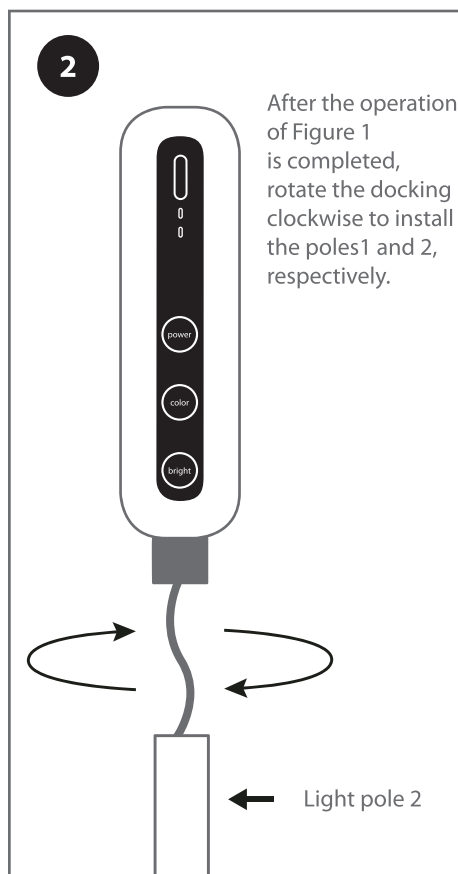
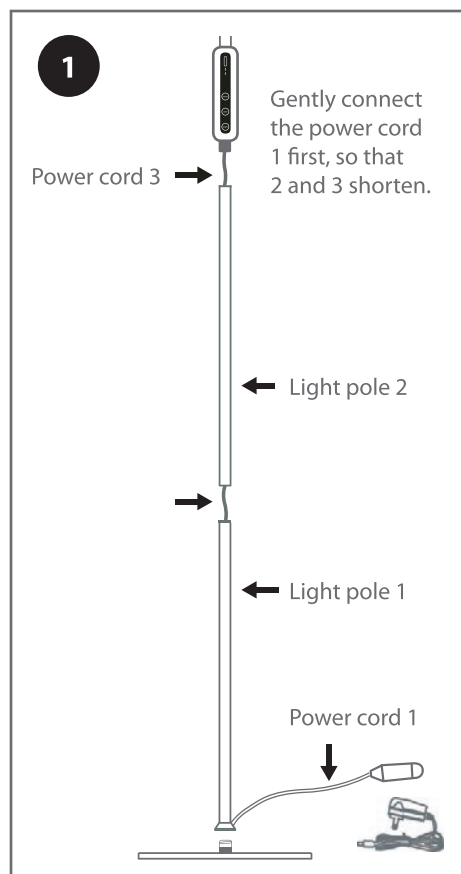

Remote control

1. (open): open key
2. (60S): 60 seconds delay turn off the lights
3. (10M): turn off the light 10 minutes delay
4. (Brightness +): Increase the brightness
5. (Brightness -): Reduce the brightness
6. (color +): Increase the color temperature
7. (color -): Reduce color temperature
8. (night light): night light function
9. (20%): Brightness 20%
10. (50%): brightness 50%
11. (100%): Brightness 100%
12. (yellow): warm light
13. (white): white light
14. (mixed light): the middle color temperature

Control panel

- Infrared sensor head
- 10 minute delay indicator
- 60 second delay indicator
- ON/OFF Switch
- Color temperature adjustment (5 step)
- Brightness adjustment (5 step)

Instrukcja instalacji i pierwsze uruchomienie:

UWAGA: Zachować szczególną ostrożność przy podłączaniu przewodu zasilania aby nie przerwać obowdu podczas montażu.

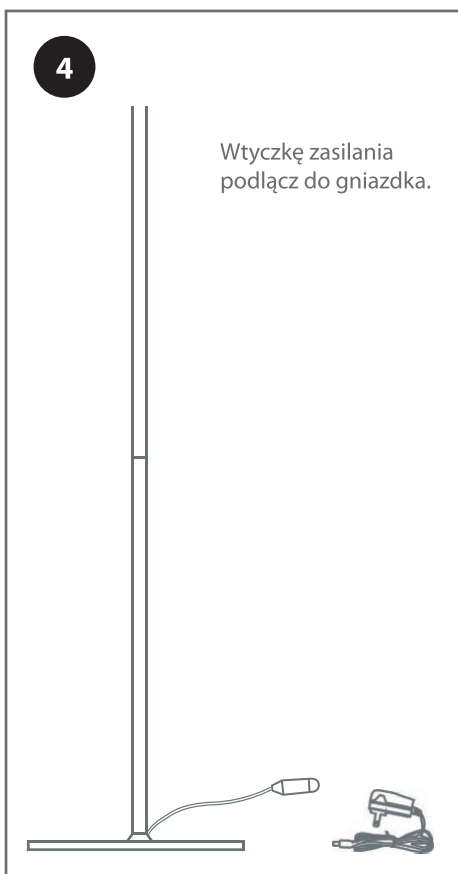
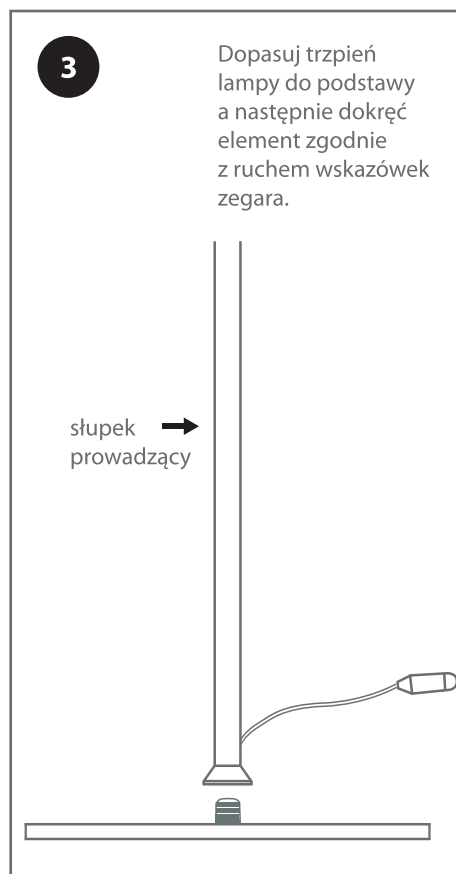
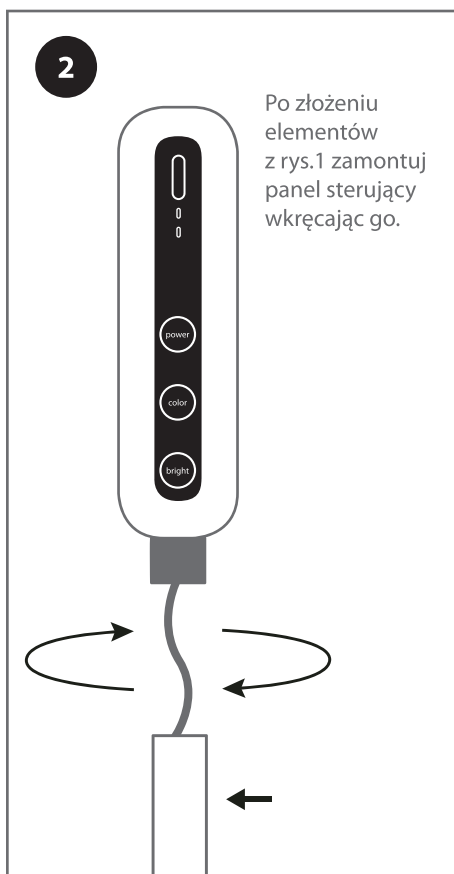
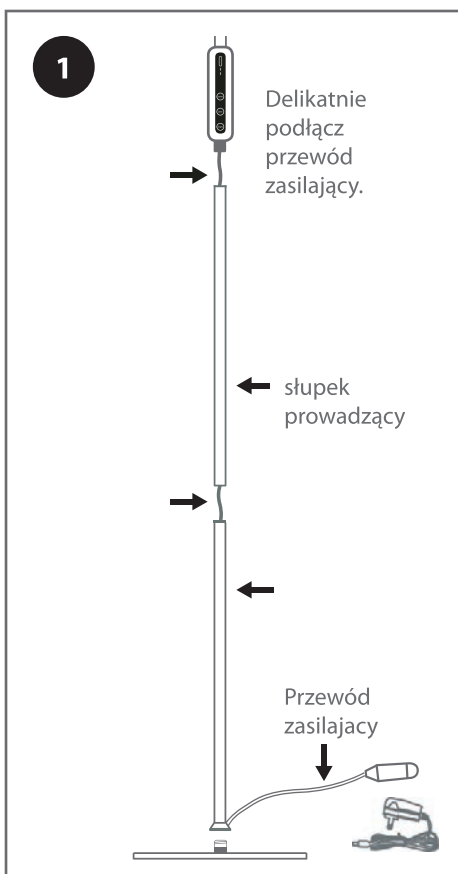

Remote control

1. Zasilanie
2. (60S) 60 sek. opóźnienia wyłączenie światła
3. (10M) 10 min. opóźnienia wyłączenie światła
4. (Brightness +): zwiększ jasność
5. (Brightness -): zmniejsz jasność
6. (color +): Zwiększ temperature barwową
7. (color -): Zmniejsz temperature barwową
8. (night light): funkcja nocnego światła
9. (20%): Jasność 20%
10. (50%): Jasność 50%
11. (100%): Jasność 100%
12. (yellow): ciepłe światło
13. (white): białe światło
14. (mixed light): średnia temperature barwowa

Control panel

- czujnik podczerwieni
- wskaźnik opóźnienia wyłączenia 10 min
- wskaźnik opóźnienia wyłączenia 60s
- power → ON/OFF włącz/ wyłącz
- color → temperatura barwowa
- bright → regulacja janości

Description du produit

Note: Ne branchez pas le cordon d'alimentation dans le poteau, sinon le cordon d'alimentation pourrait casser!

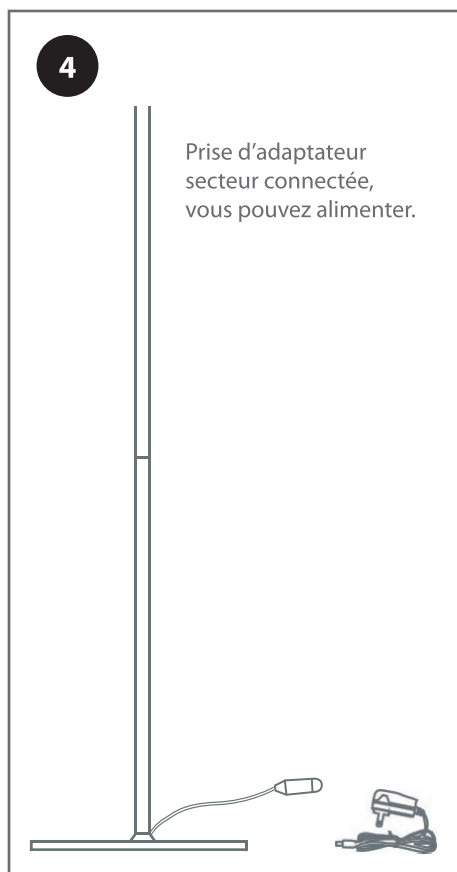
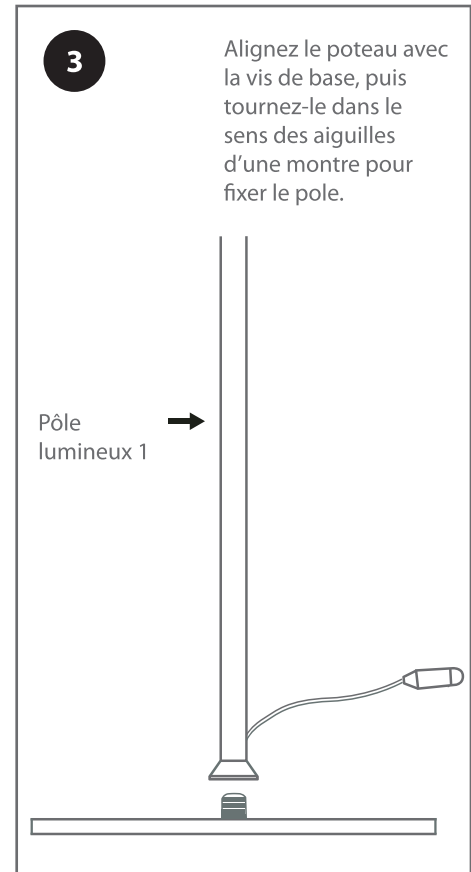
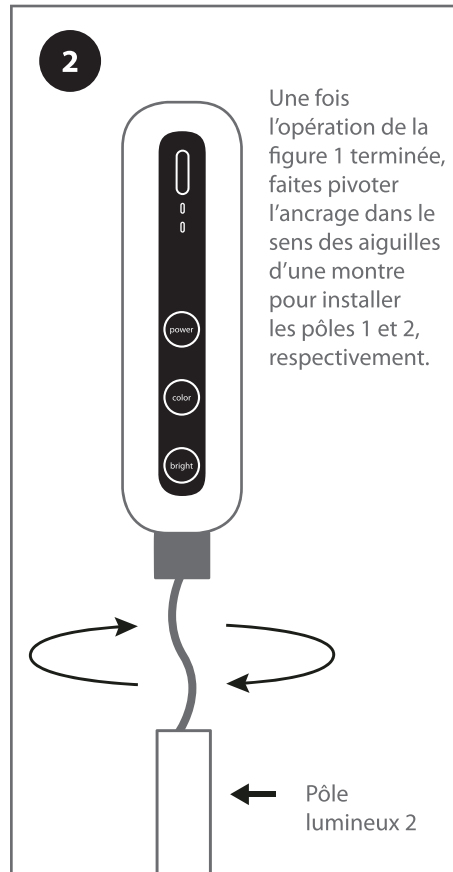
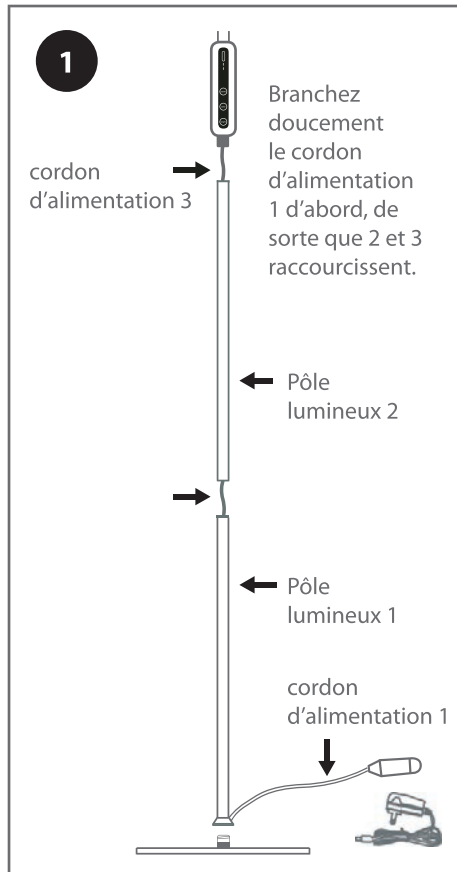

Remote control

- (Allumer): Touche d'ouverture
- (60S): 60 secondes de délai pour éteindre les lumières
- (10M): éteindre la lumière 10 minutes de délai
- (Luminosité +): Augmenter la luminosité
- (Brightness -): Réduire la brightness
- (Couleur +): Augmenter la température de couleur
- (couleur -): Réduire la température de couleur
- (veilleuse): fonction de lumière de nuit
- (20%): luminosité 20%
- (50%): luminosité 50%
- (100%): luminosité 100%
- (jaune): lumière chaude
- (blanc): lumière froide
- (lumière mélangée): la température de couleur moyenne

Panneau de contrôle

- Tête de capteur infrarouge
- Indicateur de délai de 10 minutes
- Indicateur de délai de 60 secondes
- Bouton ON/OFF
- Colou ajustement de température (5 étapes)
- Réglage de la luminosité (5 step)

Popis produktu:

Poznámky: Během montáže tyče lampy dbejte zvýšené opatrnosti, aby nedošlo k přetnutí či poničení kabelu, což může vést k nefunkčnosti výrobku či zranění!

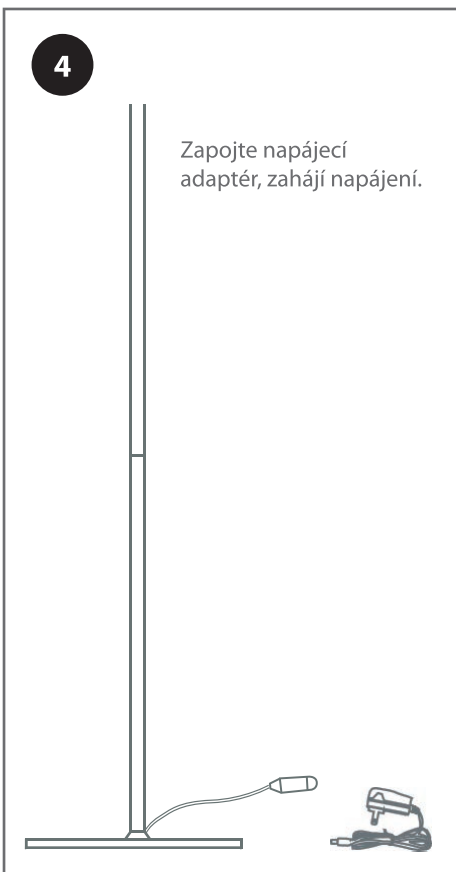
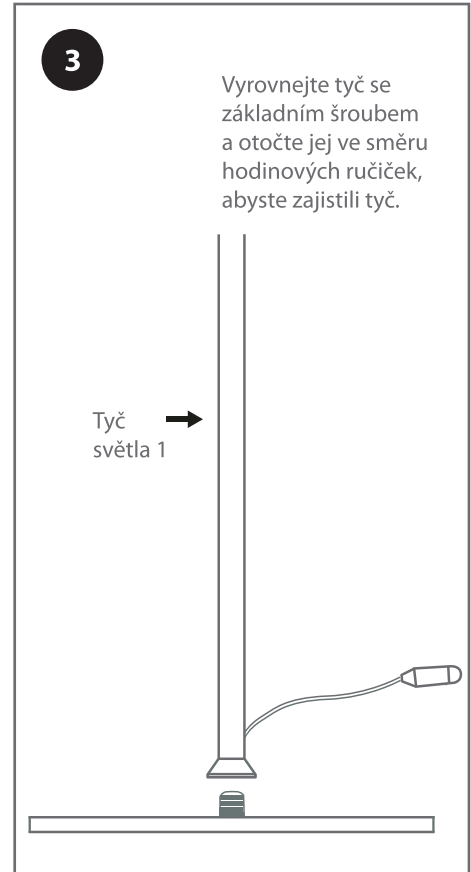
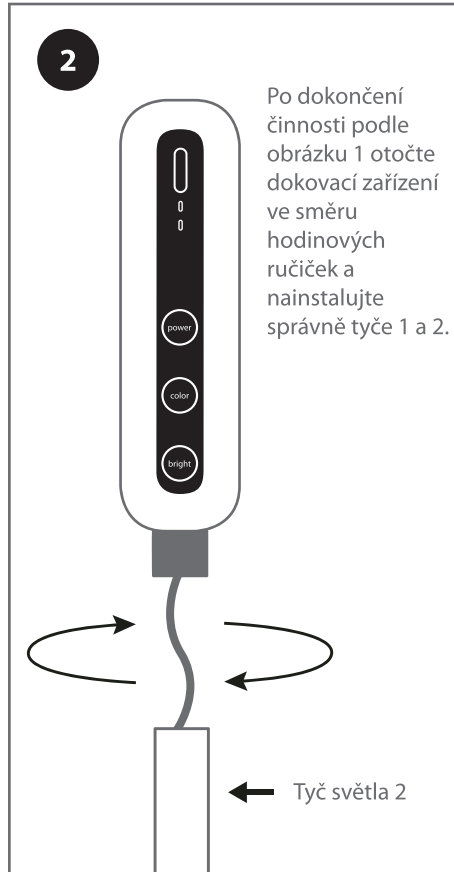
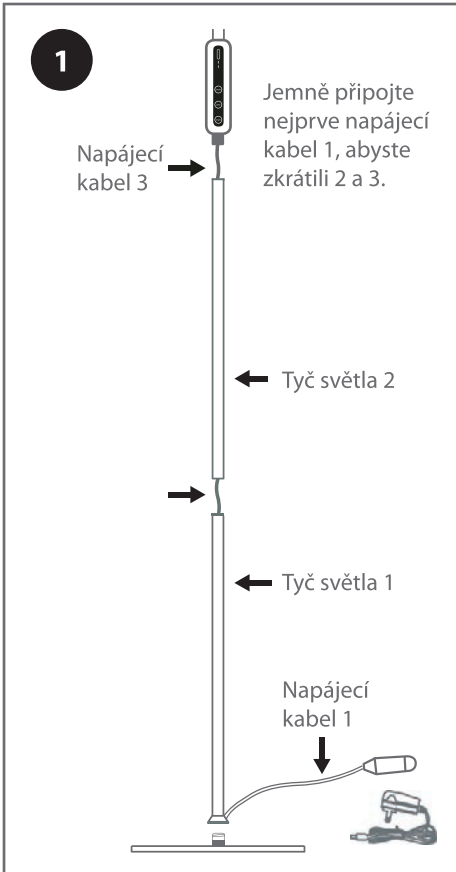

Dálkové ovládání

1. (Zapnutí): tlačítko zapnutí
2. (60S): 60s opoždění vypnutí světla
3. (10M): 10 min. opoždění vypnutí světla
4. (Jas+): Zvýšení jasu
5. (Jas-): Snížení jasu
6. (Barva +): Zvýšení teploty barev
7. (Barva -): Snížení teploty barev
8. (Noční osvětlení): funkce nočního osvětlení
9. (20%): Jas 20%
10. (50%): Jas 50%
11. (100%): Jas 100%
12. (Žlutá): teplé světlo
13. (Bílá): bílé světlo
14. (Smíšené světlo): střední teplota barev

Kontrolní panel

- Infračervené senzory
- 10 min. – indikátor opoždění
- 60 s. – indikátor opoždění
- ON/OFF
- Nastavení teploty barev (5 stupňů)
- Nastavení jasu (5 stupňů)

Popis produktu

Poznámky: Počas montáže tyče lampy dbajte na zvýšenú opatnosť, aby nedošlo k pretiahnutiu či zničeniu kábla, čo môže viesť k nefunkčnosti výrobku či zranenia!

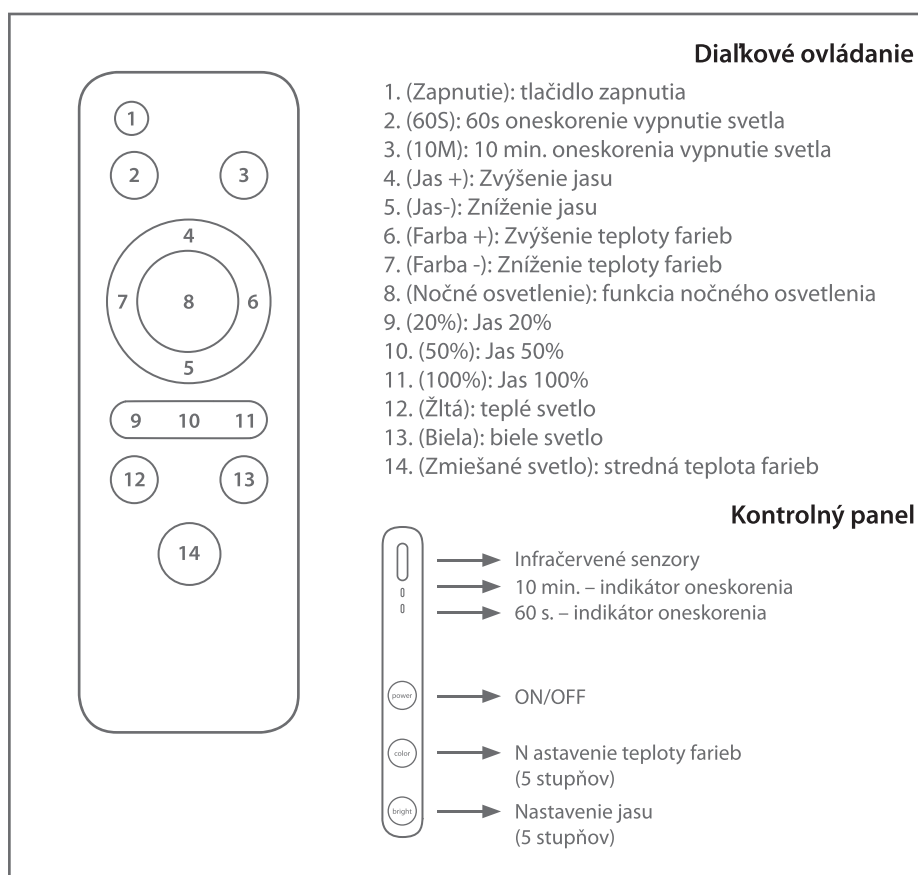
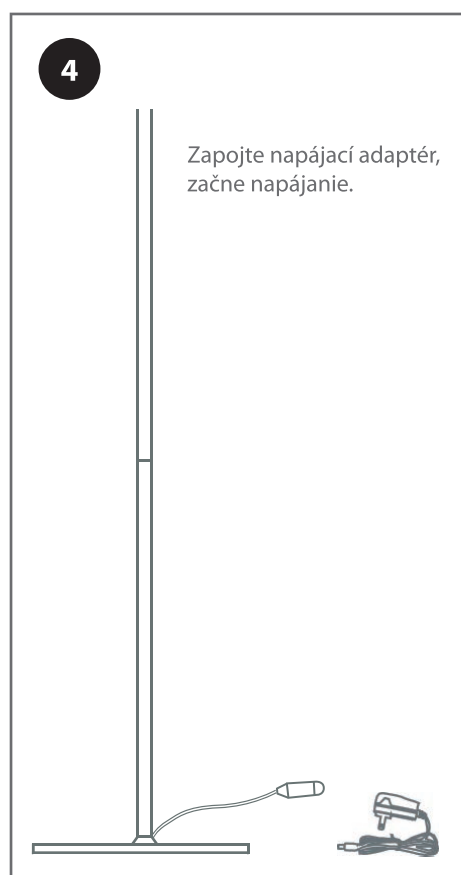
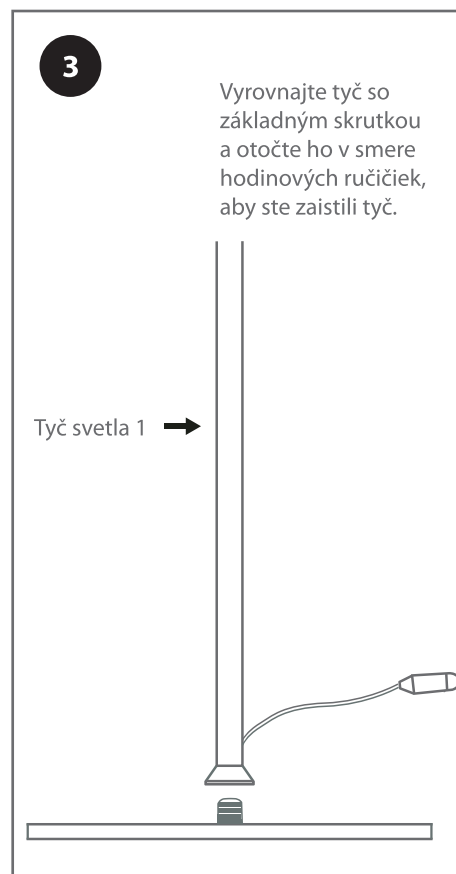
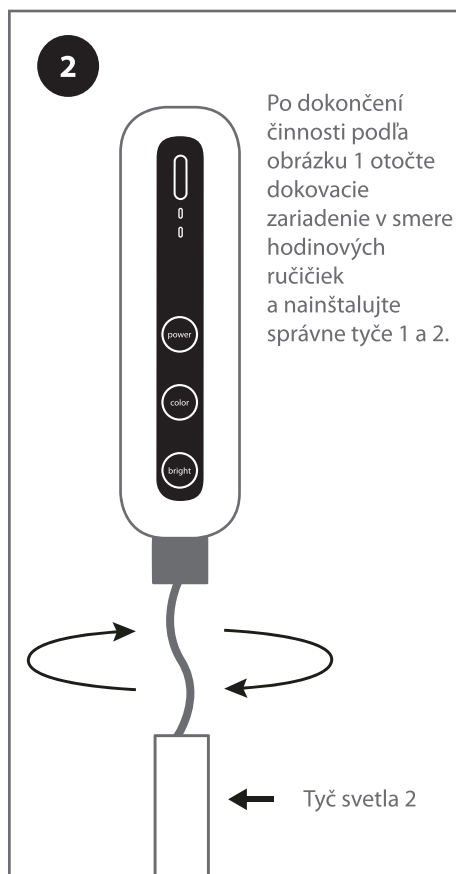
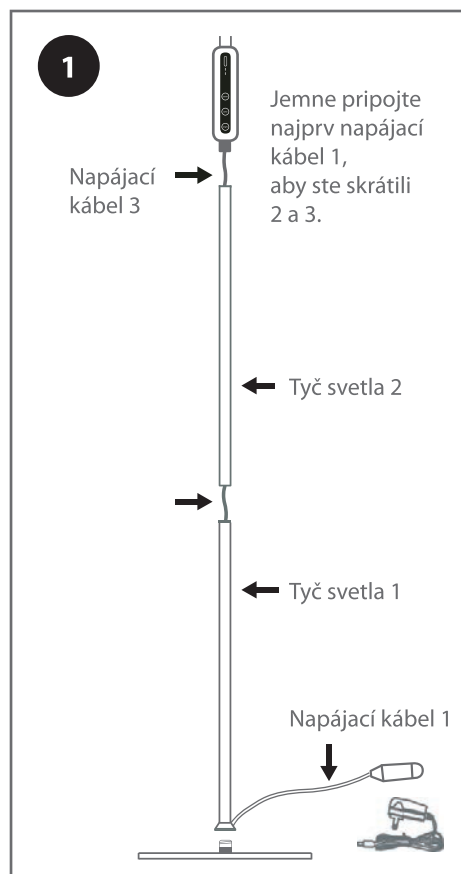

Descripcion producto

Nota: No conecte el cable de alimentación al poste; de lo contrario, el cable de alimentación se romperá!

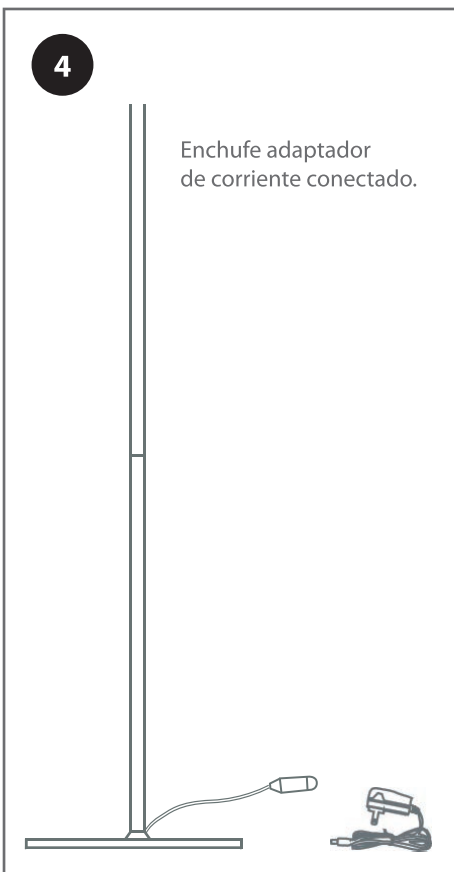
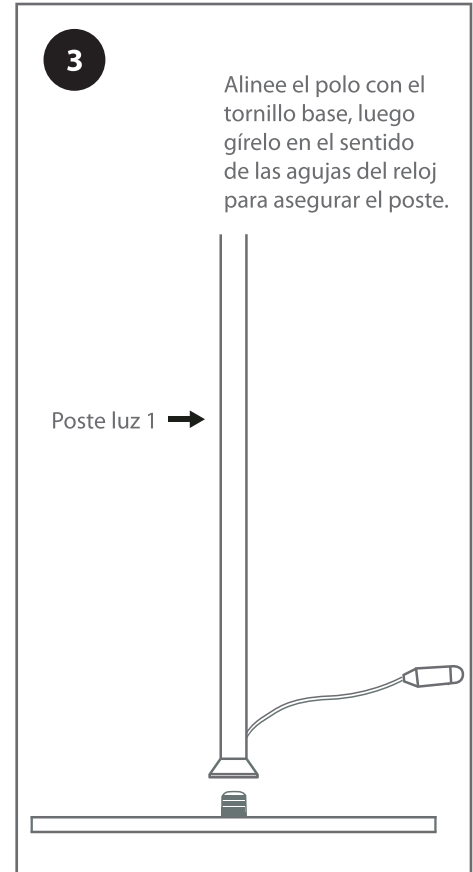
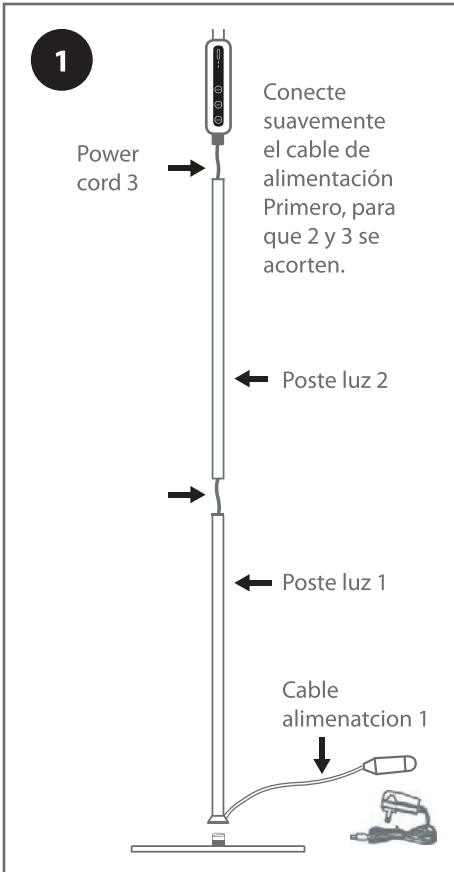

Control Remoto

1. (Abrir): Encender
2. (60S): Retrasa 60 segundos para apagar las luces
3. (10M): Retrasa 10m para apagar las luces
4. (Brillo +): Incrementa el brillo
5. (Brillo -): Reduce the brightness
6. (Color +): Incrementa la temperature color
7. (Color -): Reduce la temperature color
8. (Luz noche): Funcion Luz noche
9. (20%): Birlo al 20%
10. (50%): Birlo al 50%
11. (100%): Birlo al 100%
12. (Amarilla): Luz cálida
13. (Blanco): Luz fría
14. (Mulz mixta): Color temperature mixta

Panel Control

- Sensor Infrarrojos Infrared
- Indicador retraso 10 minutos
- Indicador retraso 60 segundos
- power → Interruptor ON/OFF
- color → Ajuste Color temperatura (5 pasos)
- bright → Ajuste Brillo (5 pasos)

Descrizione del prodotto

Nota: non inserire il cavo di alimentazione nel polo, altrimenti il cavo di alimentazione si spezzerà!

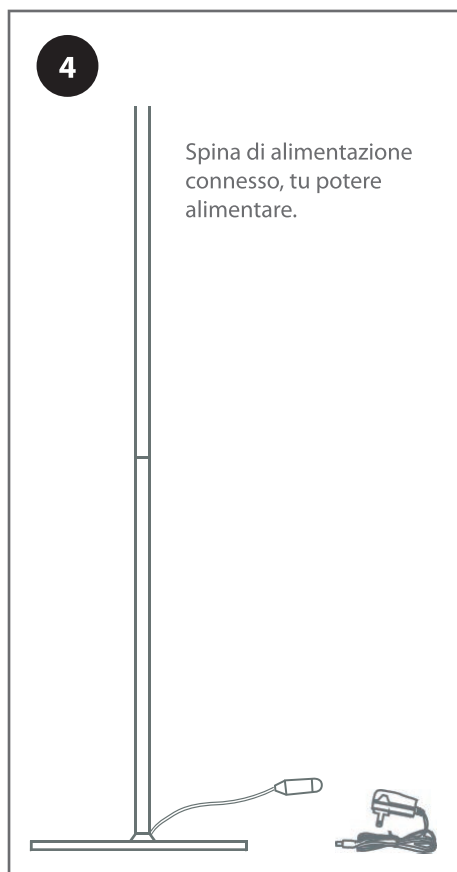
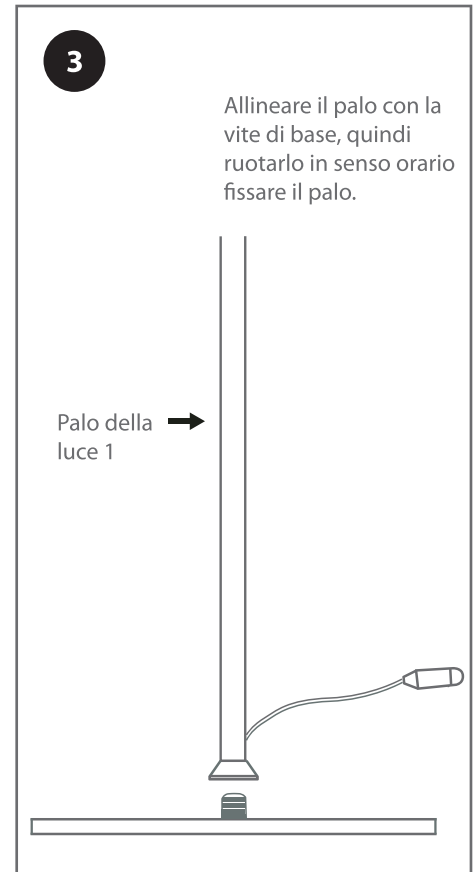
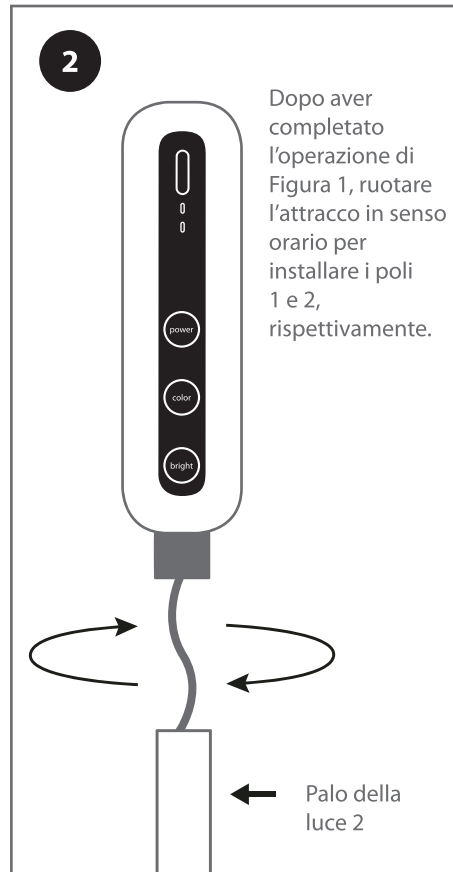
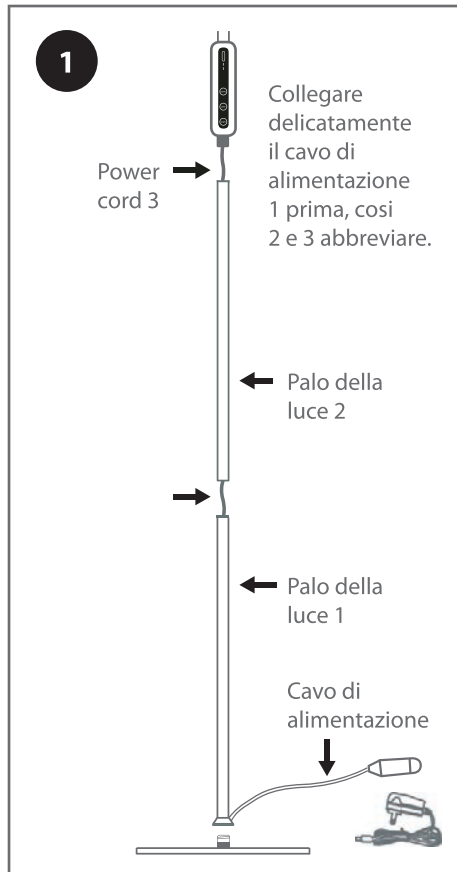

Telecomando

1. (aperto): chiave aperta
2. (60S): 60 secondi di ritardo per spegnere le luci
3. (10M): spegni la luce per 10 minuti
4. (Luminosità +): aumenta la luminosità
5. (Luminosità -): riduce la luminosità
6. (Colore +): aumenta la temperatura del colore
7. (Colore -): riduce la temperatura del colore
8. (Luce notturna): funzione luce notturna
9. (20%): Luminosità 20%
10. (50%): Luminosità 50%
11. (100%): Luminosità 100%
12. (giallo): luce calda
13. (bianco): luce bianca
14. (luce mista): la temperatura del colore centrale

Pannello di controllo

- Infratestina del sensore
- 10 indicatore di ritardo minuto
- 60 secondo indicatore di ritardo
- ON/OFF Interruttore
- Temperatura di colore regolazione (5 step)
- Regolazione della luminosità (5 step)

Descriere produs

Notă: nu introduceți priza înăuntru ca să nu distrugeți cordonul!

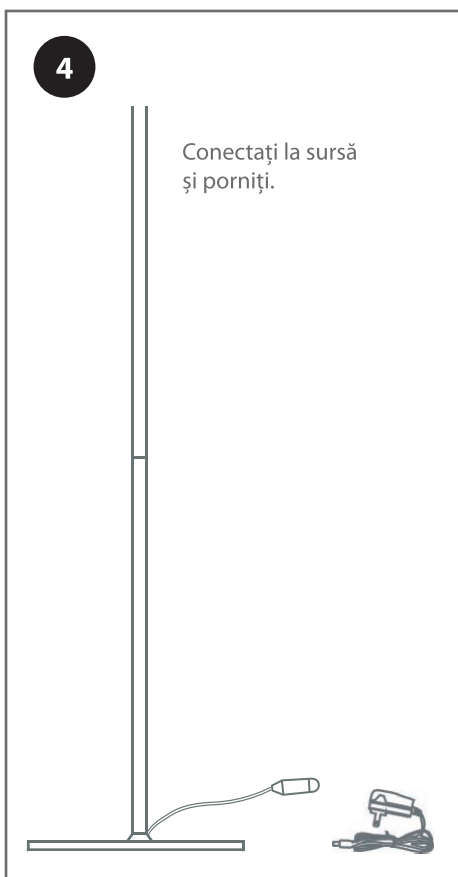
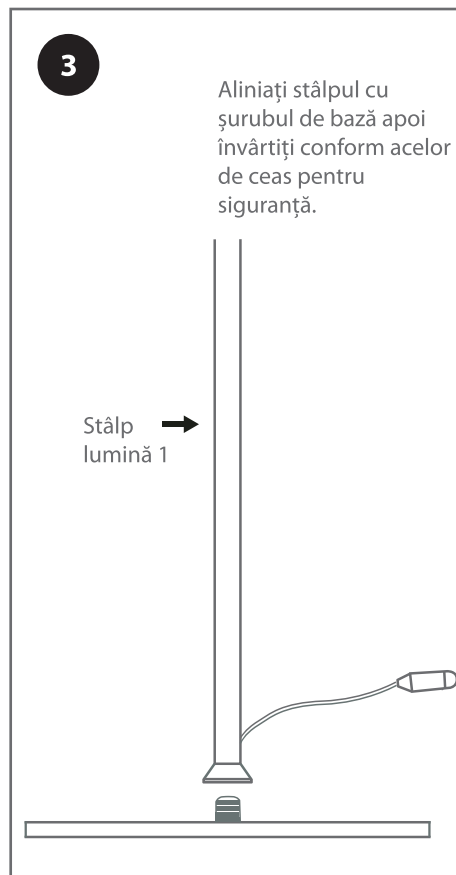
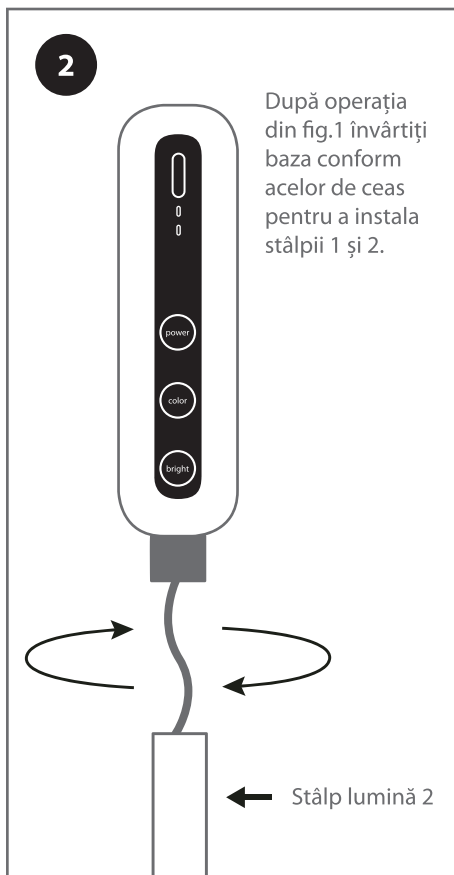
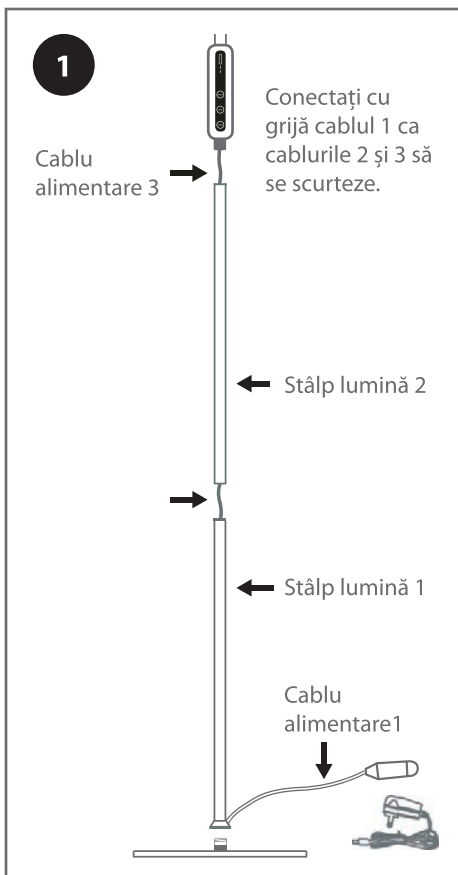

Telecomandă

1. (Open): Pornire
2. (60S): Întârziere 60 secunde
3. (10M): Întârziere 10 minute
4. (Brightness +): Mărește intensitatea
5. (Brightness -): Reduce intensitatea
6. (Color +): Mărește temperatura culorii
7. (Color -): Reduce culoarea temperaturii
8. (Night light): Funcție lumină de noapte
9. (20%): Intensitate 20%
10. (50%): Intensitate 50%
11. (100%): Intensitate 100%
12. (Yellow): Lumină caldă
13. (White): Lumină albă
14. (Mixed light): Culoarea intermediară a culorii de temperatură

Control panel

- Cap senzor cu infraroșu
- Indicator întârziere 10 minute
- Indicator întârziere 60 secunde
- ON/OFF comutator pornire/oprire
- Ajustare a culorii de temperatură (5 pași)
- Ajustare intensitate (5 pași)

Описание продукта

Примечание. Не подключайте шнур питания к полюсу, иначе шнур питания сломается!

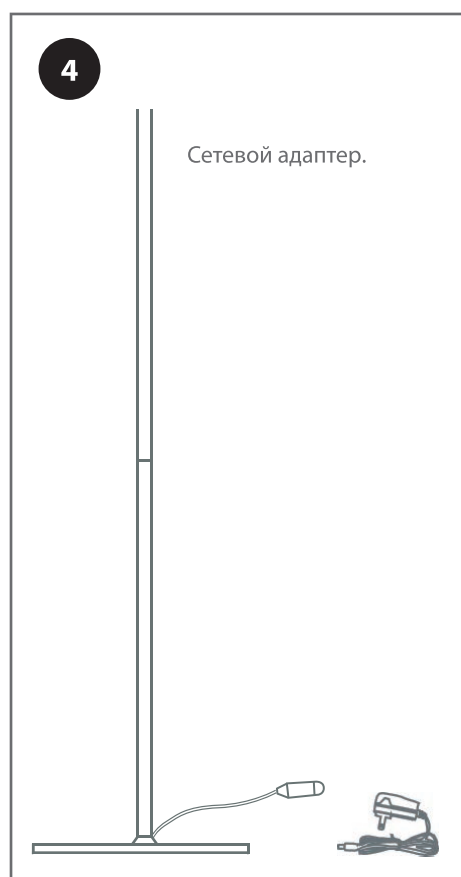
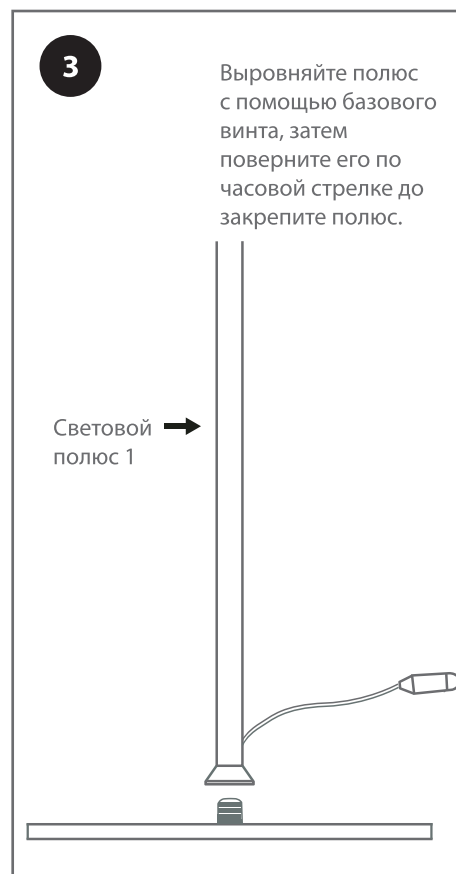
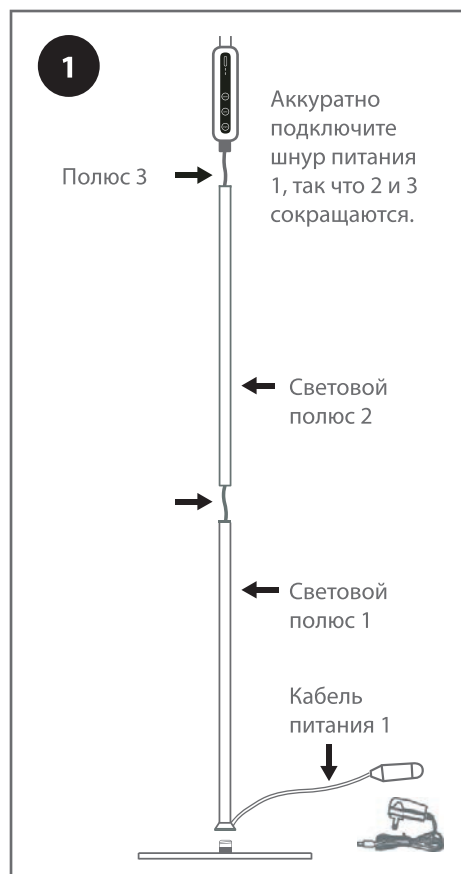

Пульт управления

- (Открыть): Открыть ключ
- (60S): Задержка в 60 секунд включает в себя огни
- (10M): Включите свет 10 минут задержки
- (Яркость +): Увеличение яркости
- (Яркость -): Уменьшите яркость
- (Цвет +): Увеличить цветовую температуру
- (Цвет -): Уменьшить цветовую температуру
- (Ночной свет): Функция ночного освещения
- (20%): Яркость 20%
- (50%): Яркость 50%
- (100%): Яркость 100%
- (Желтый): Теплый свет
- (Белый): Белый свет
- (Смешанный свет): Средняя цветовая температура

- Инфракрасный сенсор
- 10 сек. Задержка (индикатор)
- 60 сек. Задержка (индикатор)
- ВКЛ/ ВЫКЛ
- Регулировка цветовой температуры (5 шагов)
- Регулировка яркости (5 шагов)

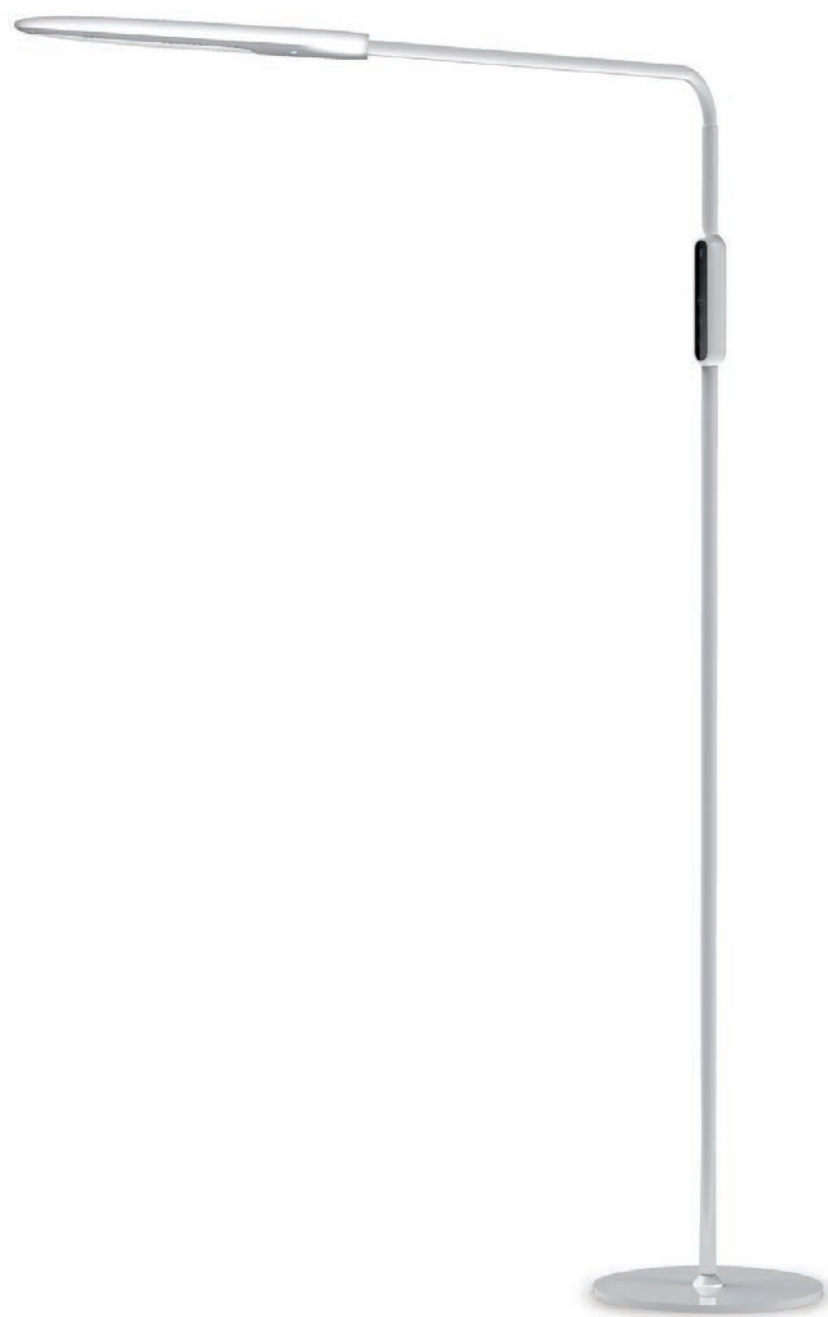

PLATINET S.A.
30-798 Kraków, Sliwiaka 48, PL
www.platinet.eu

Importator:
PLATINET ELECTRONICS SRL
077065 CORBEANCA, JUD ILFOV
str. PISCULUI 10A/2, RO
tel.: 0 742 233 799, officero@platinet.eu
www.platinet.eu