

Modellname: **Opti**
 Nazwa modelu:

Modellreihe: **9X -- OP 32**
 Numer modelu:

Type:
 Typ:

Blatt Nr **1** von: **4**
 Strona **1** z:

Pflegehinweis!

Bitte nur mit einem Staubtuch oder einem feuchten Lappen reinigen.
KEINE scheuernde Putzmittel verwenden!

Wskazówka dotycząca pielęgnacji!

Proszę czyścić tylko suchą lub lekko wilgotną szmatką do kurzu. Nie używać żadnych środków szorstkich!

MONTAGEANLEITUNG
INSTRUKCJA MONTAŻOWA

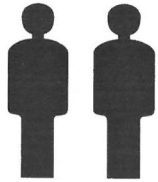

2 Personen
2 Osoby

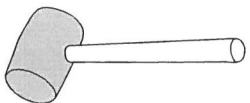
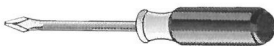
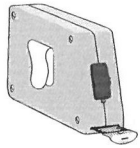

Max. zulässige Belastungen
 von Einlegeböden in kg:
 Maksymalne obciążenie półek w kg:

| Stärke/Gr. | Spanplatte/Płyta | | |
|--------------|------------------|----|----|
| Länge/Dł. mm | 15 | 18 | 22 |
| 0<400 | | | |
| 401<600 | 40 | 40 | 40 |
| 601<800 | 24 | | |
| 801<1000 | 15 | 30 | |

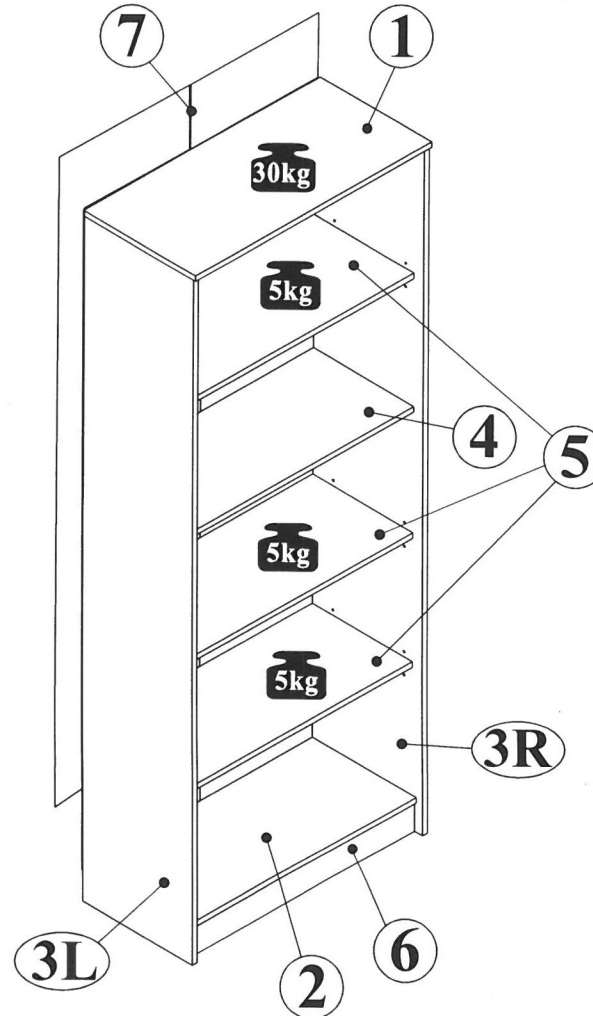

NR 1

- B1** 8x28 x12
- M1** x12
- T1** x12
- W1** x12
- F33** x3
- P13** 3,5x13 x12
- F15** x6
- S6** 3x20 x32
- C14** φ20mm x8

NR 2

- J11** x2
- P13** 3,5x13 x4

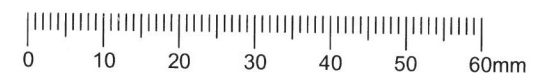

Modellname: **Opti**
Nazwa modelu:

Modellreihe: **9X -- OP 32**
Numer modelu:

Type:
Typ:

Blatt Nr 2 von: 4
Strona z:

1

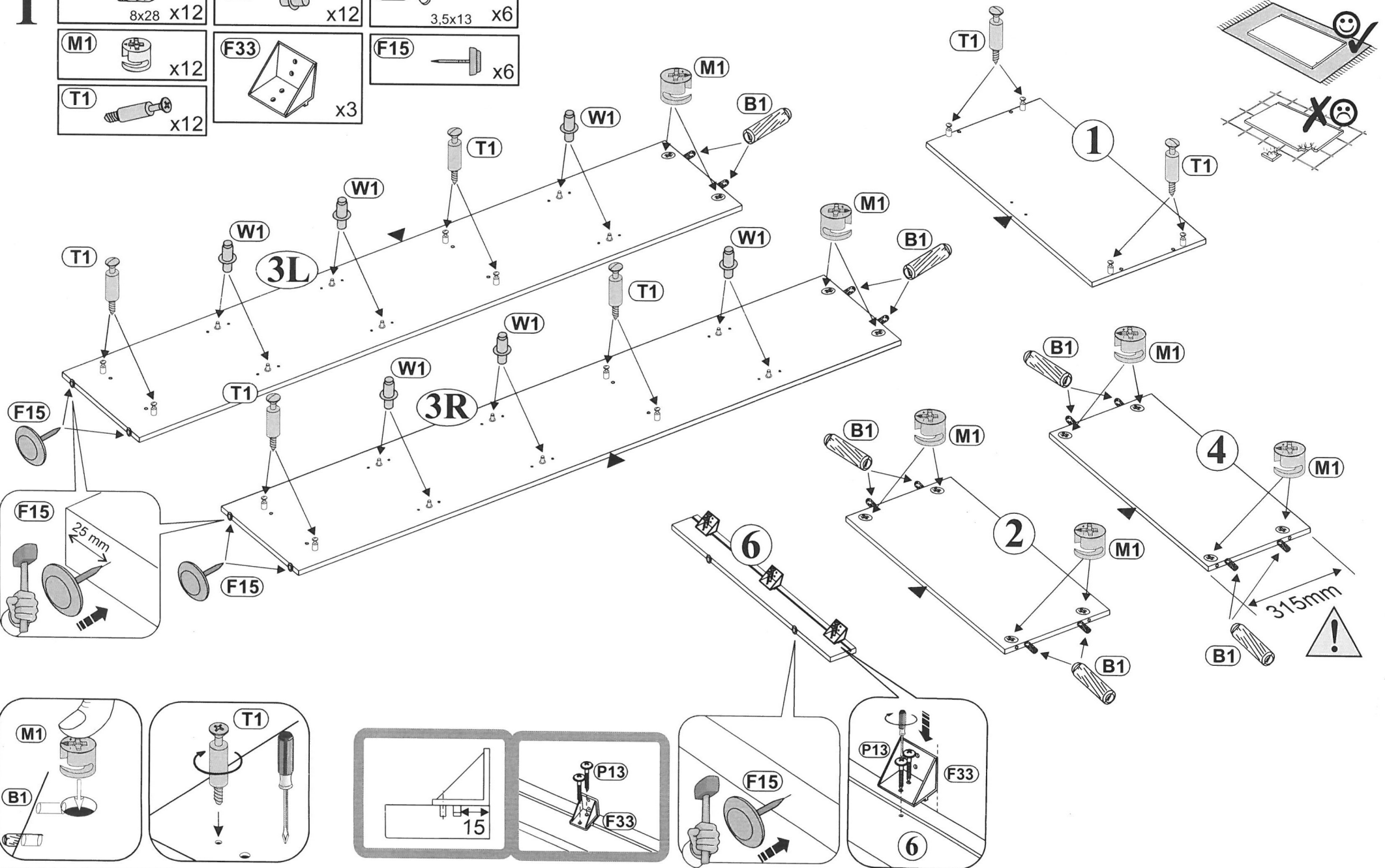
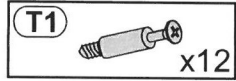
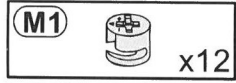
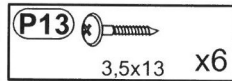
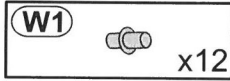
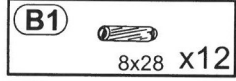

2

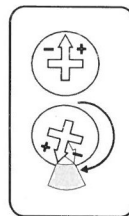
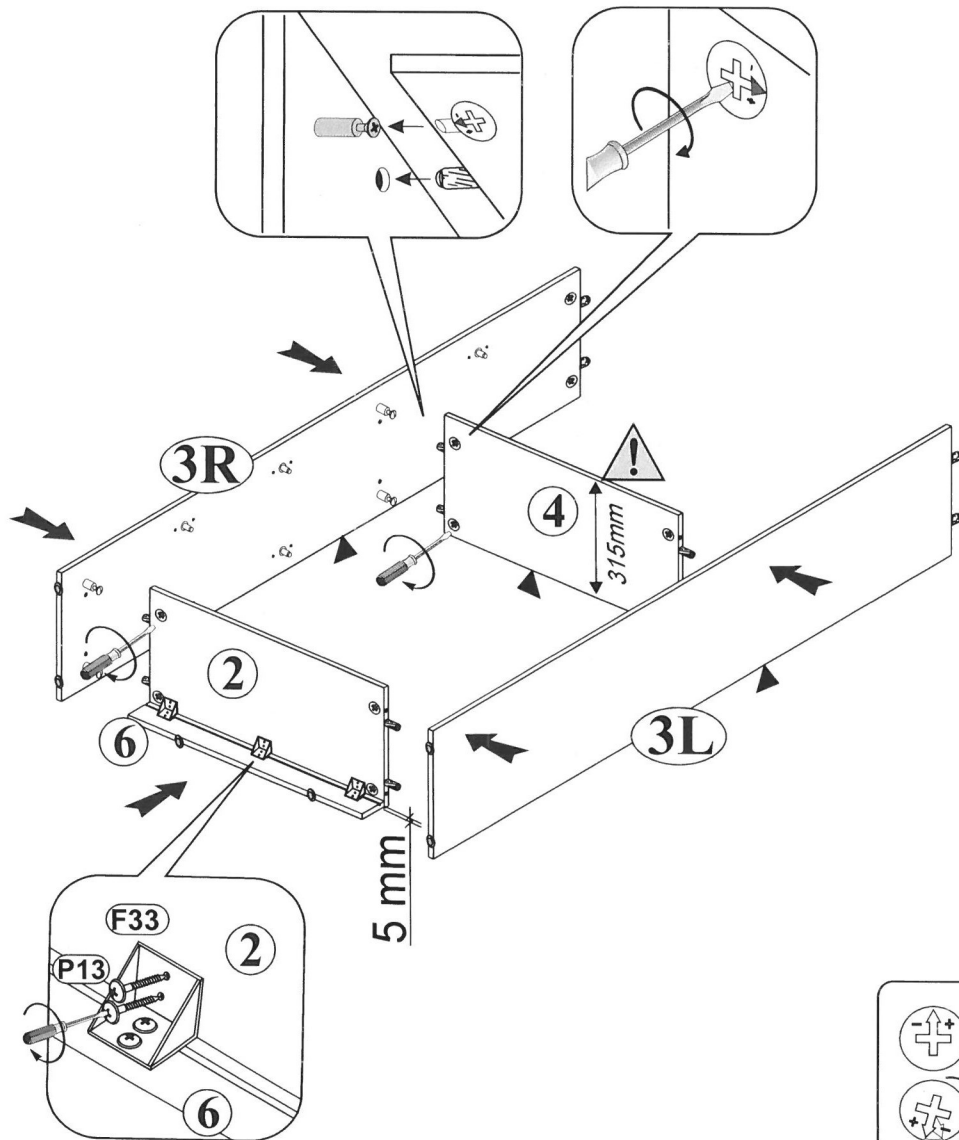
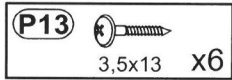

3

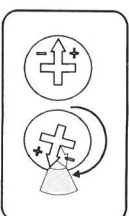
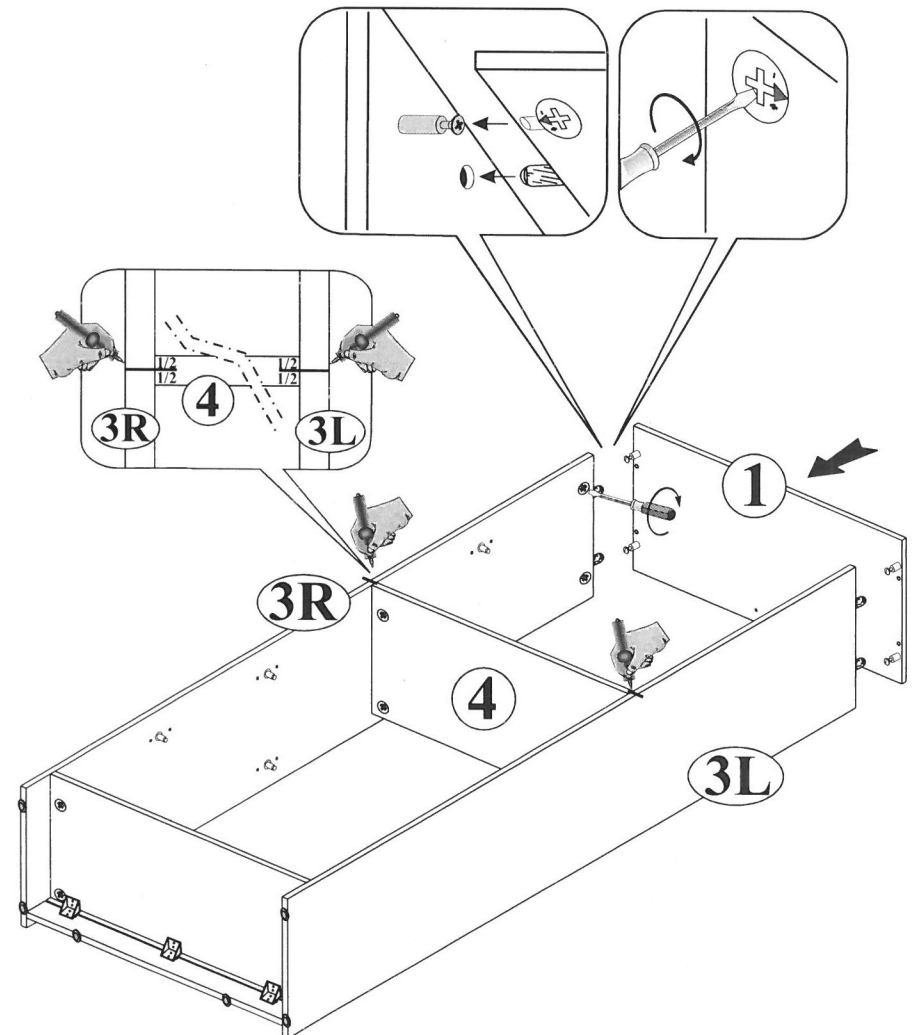

4

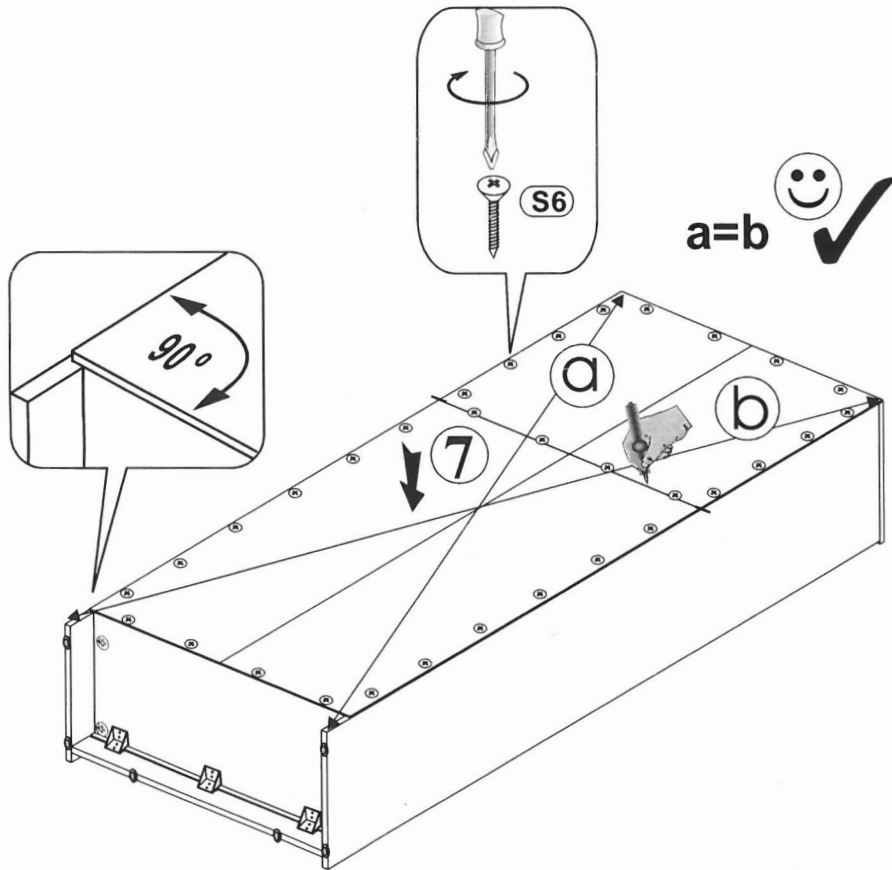
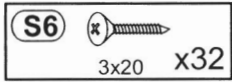

5

