

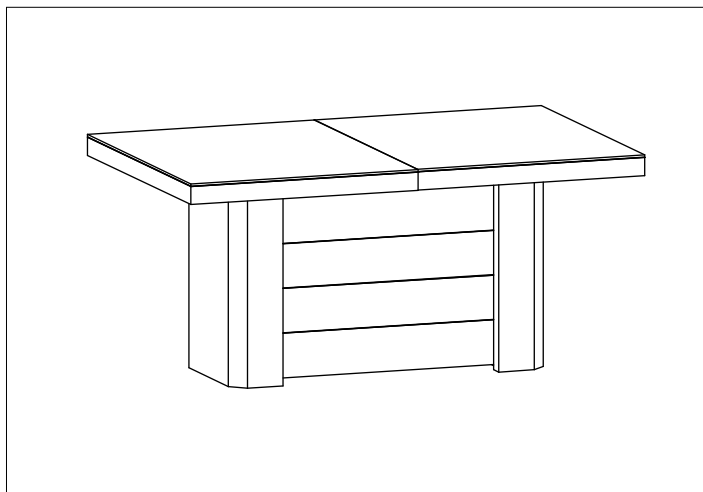

Hubertus DESIGN

HUBERTUS DESIGN sp. z o.o.
ul. Srokowiecka 22 | 41-100 Siemianowice Śląskie

- | | |
|----------------------------------|------------------------------|
| (D) Montageanleitung | (GB) Assembly instructions |
| (NL) Handleiding voor de montage | (PL) Instrukcja montażu |
| (TR) Montaj talimatı | (RU) Инструкция по монтажу |
| (RO) Instrucțiunile de asamblare | (CZ) Montážní návod |
| (IT) Istruzioni per il montaggio | (FR) Instructions de montage |
| (SK) Montážny návod | (HU) Szerelési útmutató |



KOLOS

03 - 01/2021

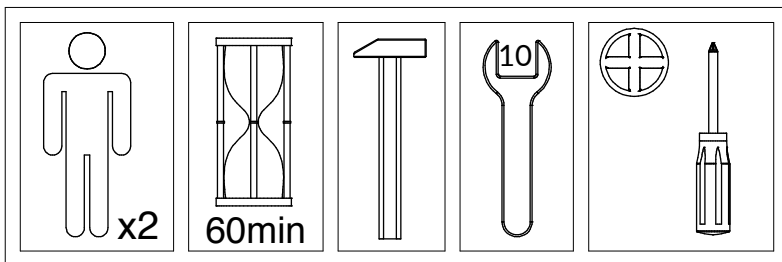

ew5 x20 euro 5 x 13	nw x4 Ø10 x 13	w16 x16 Ø3,5 x 16	m x30 Ø15	f x10 filc
t x16 L-24	l x24 Ø7,5 x 30	s16 x8 M5 x 16	s30 x8 M6 x 30	x8
td x14 L-28	n5 x8 M5	n6 x8 M6	s50 x4 M6 x 50	x4
z4(z3) x1(x1) Ø5 x 10	p5 x16 Ø5 x 10	p6 x8 Ø6 x 12	x8	x8
k30 x12 Ø5 x 30	s x8 Ø5 x 30	ko x8 Ø5 x 30	x8	x8

„KOLOS” - 10 - x4

„KOLOS 2” - 10 - x2

w16

x50

zz

x10

z

x10

w16

x30

zz

x6

z

x6

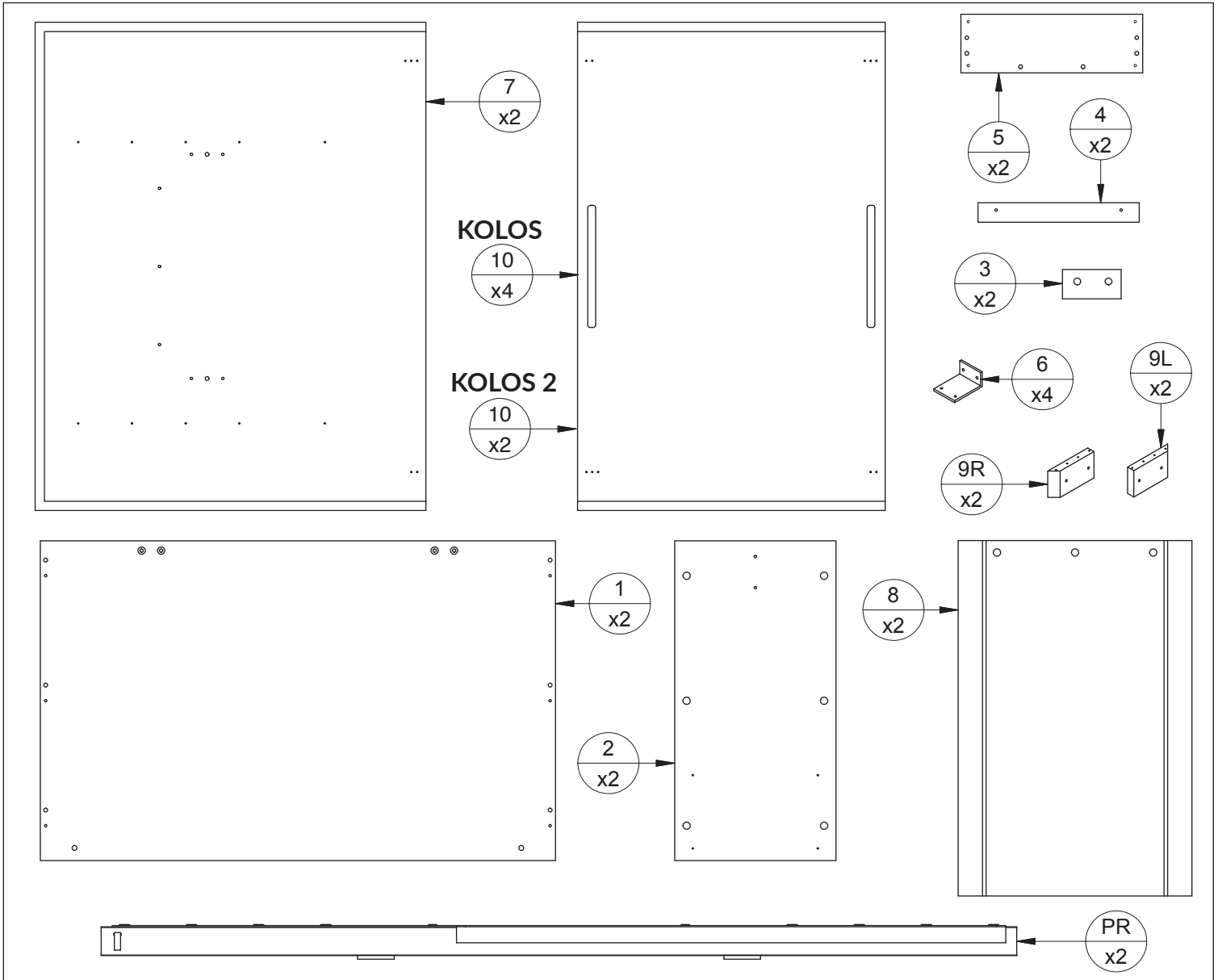
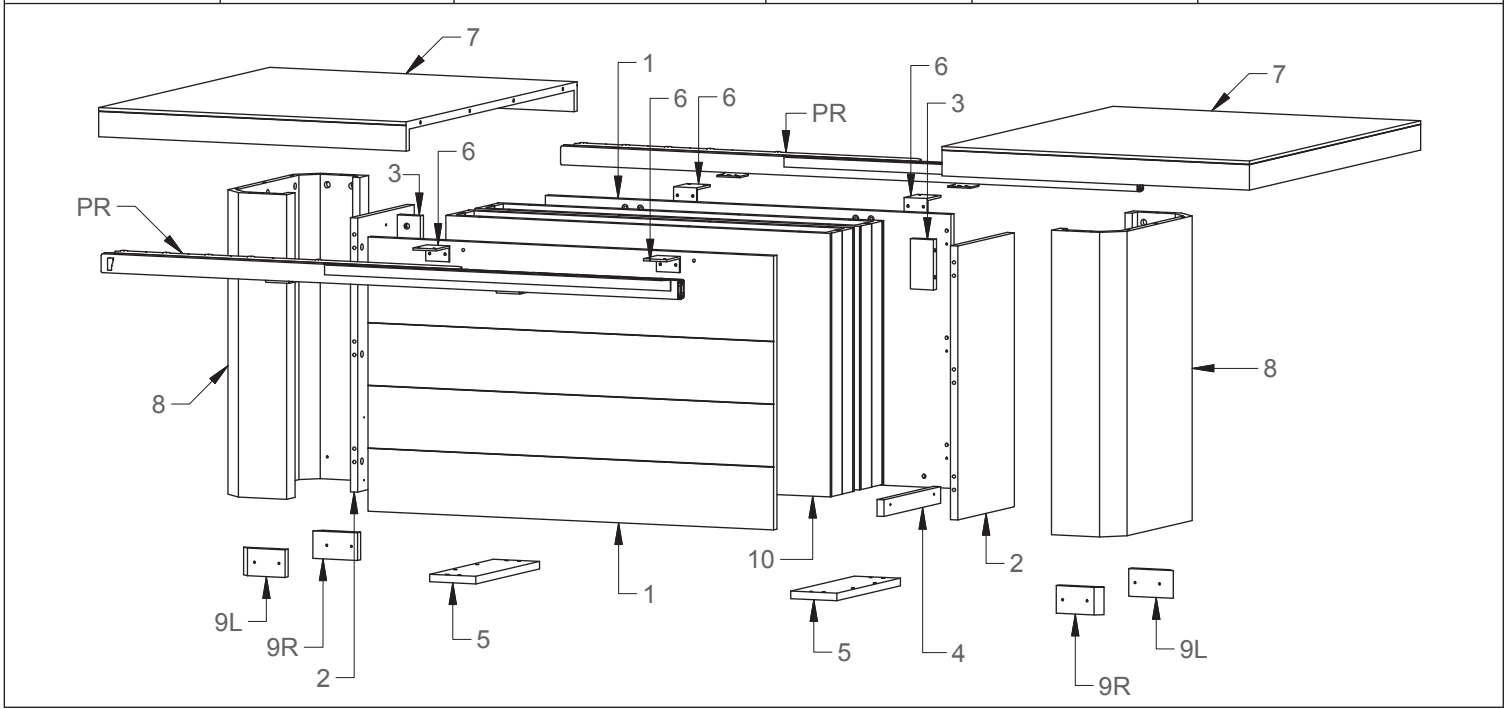
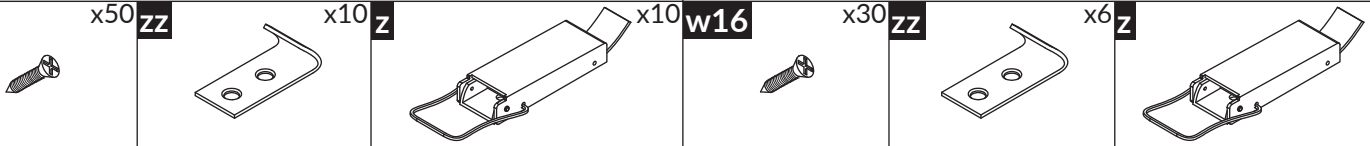

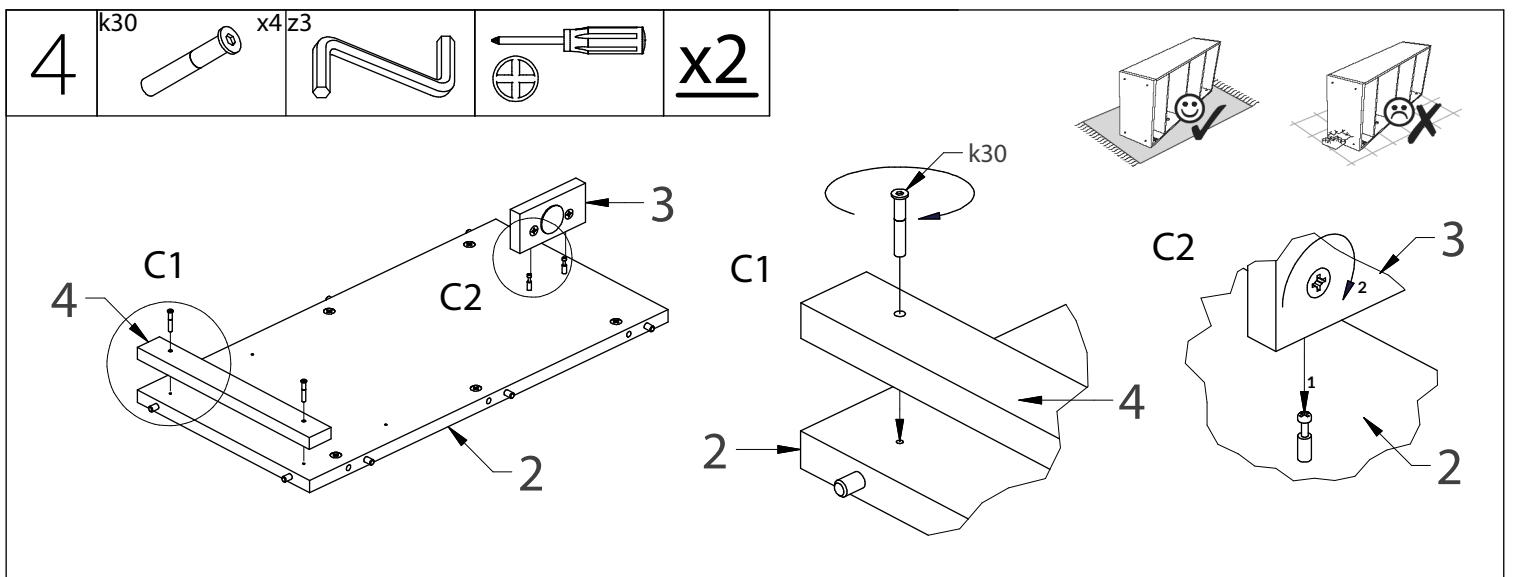
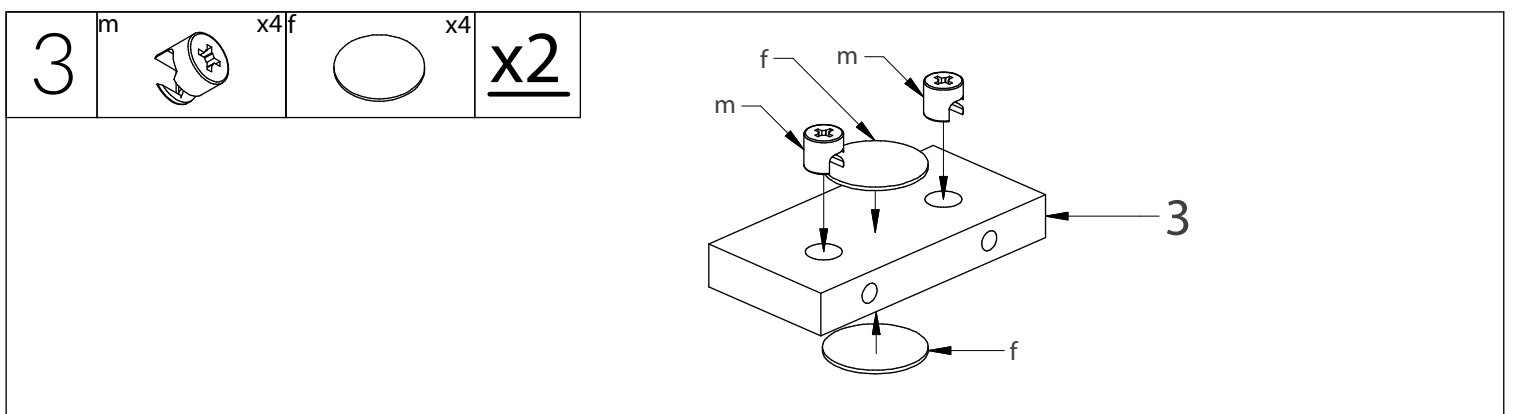
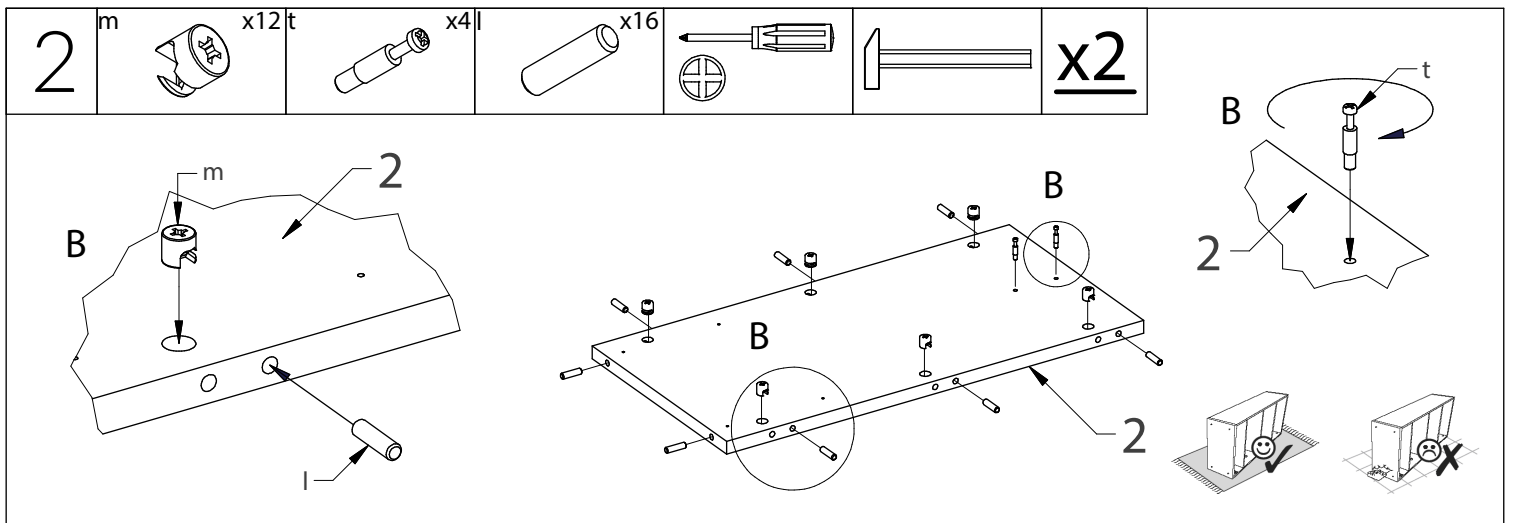
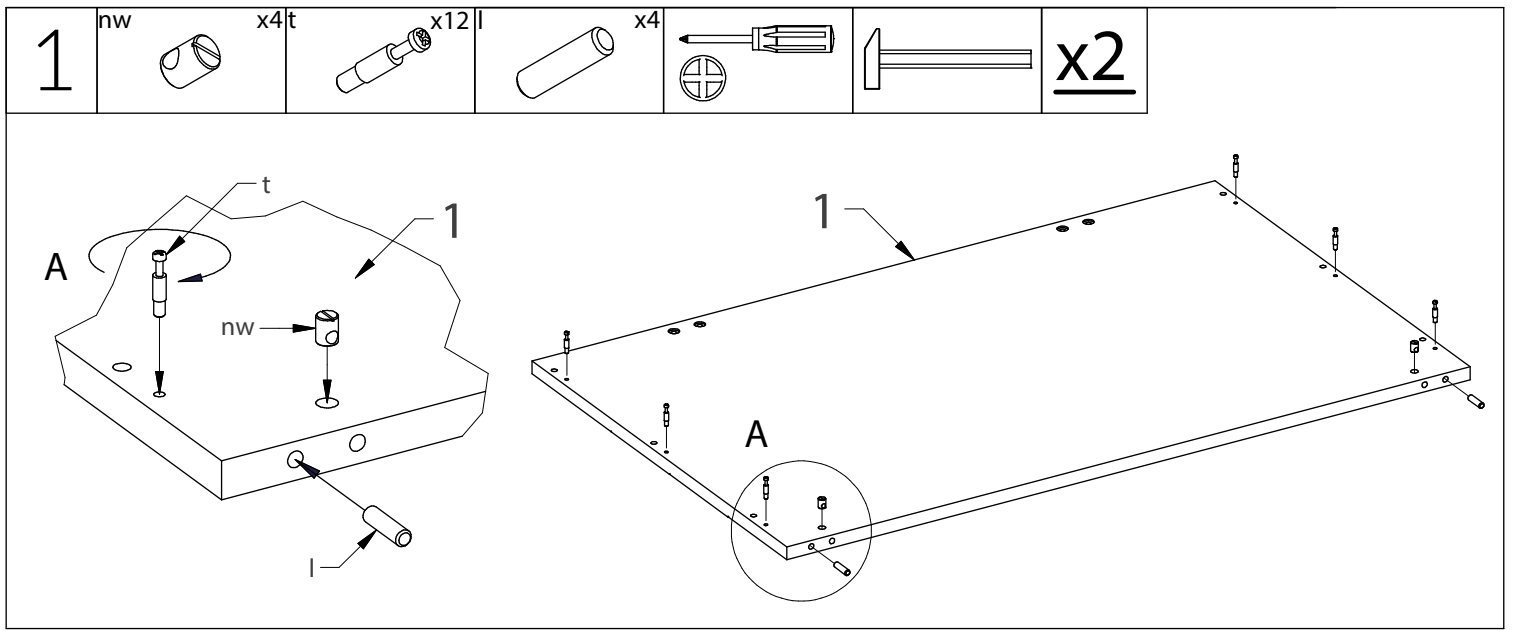

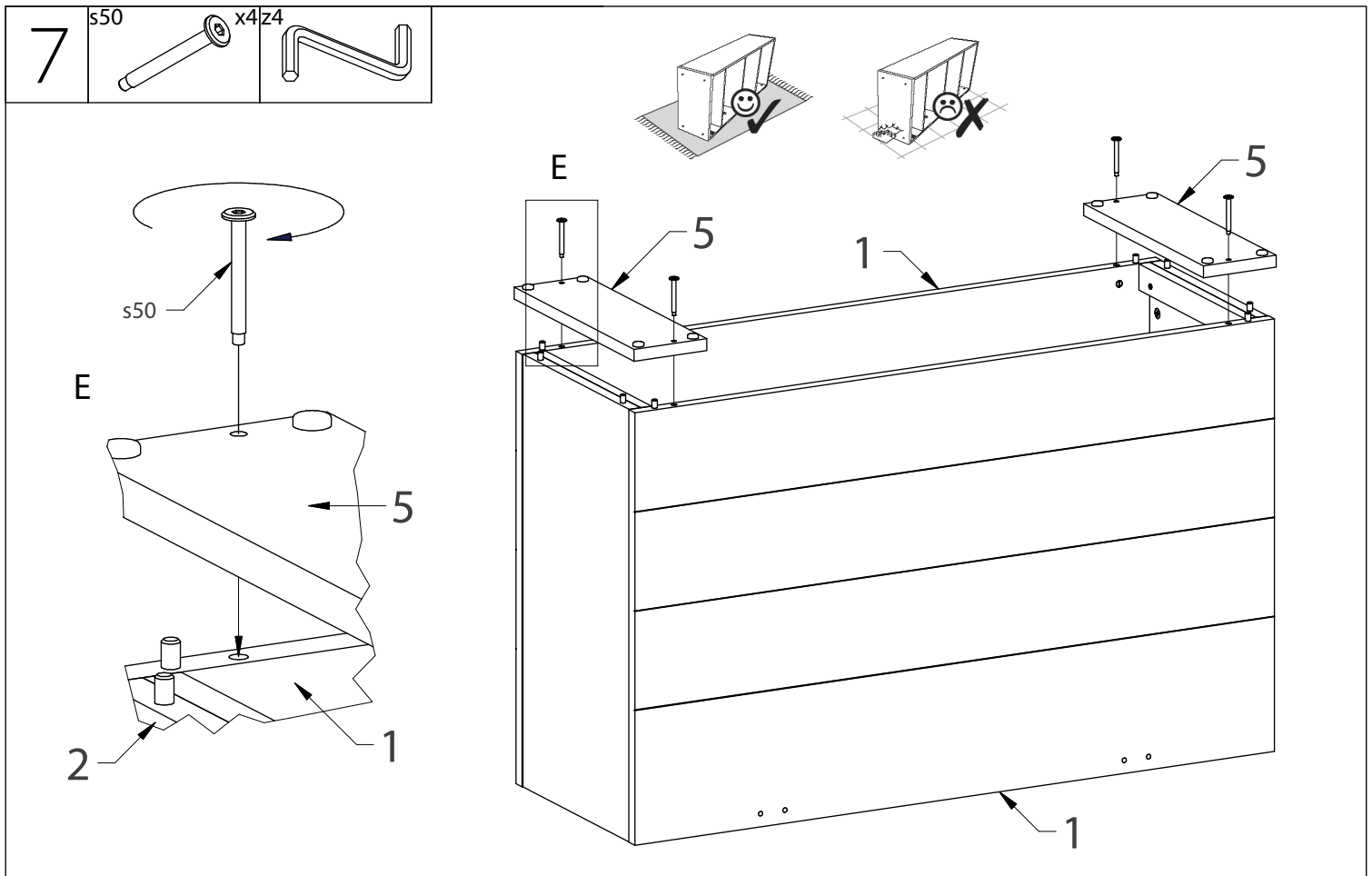
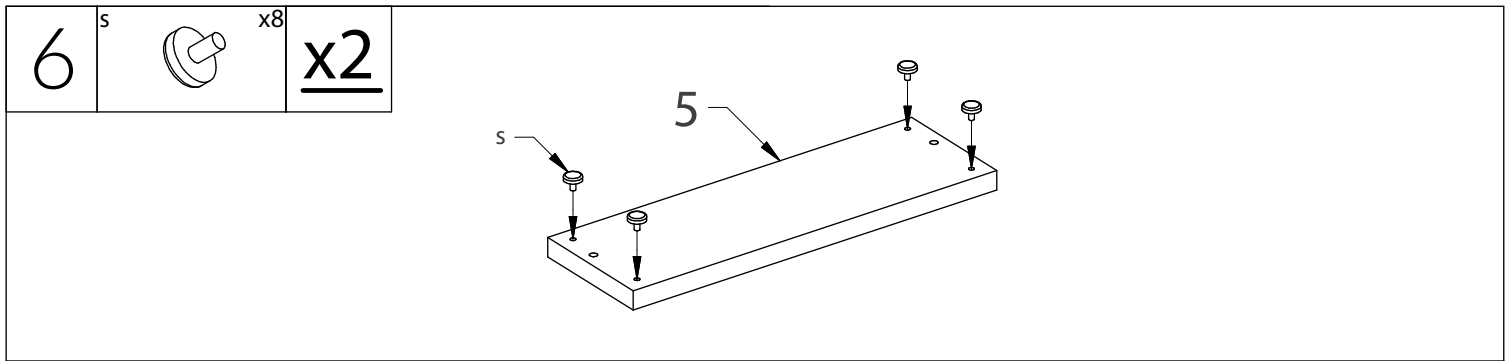
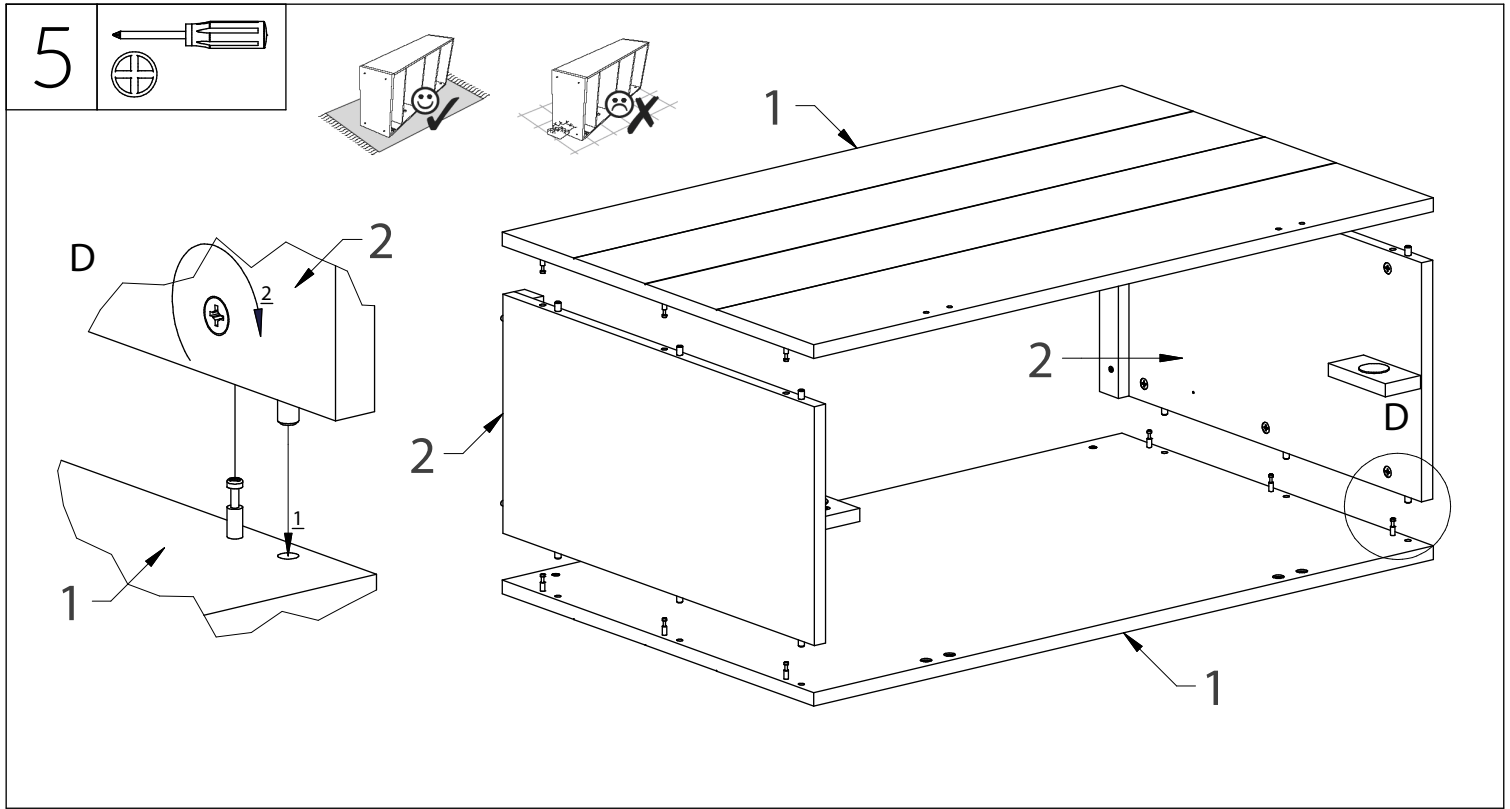

8

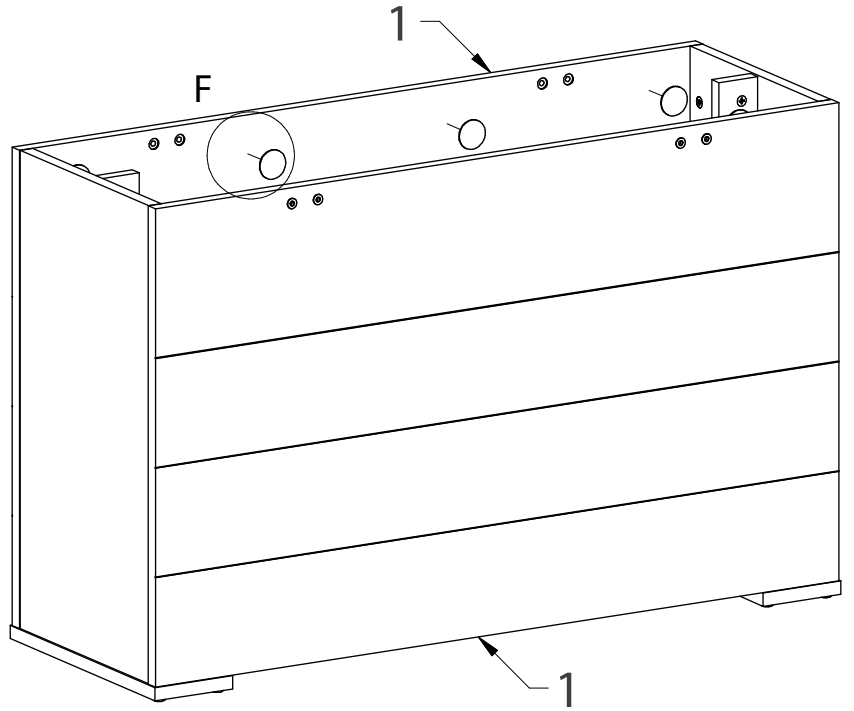
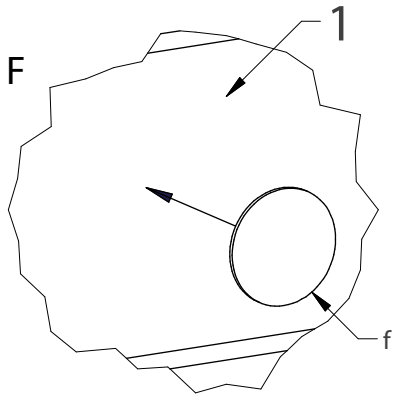
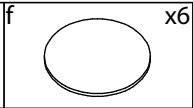

9

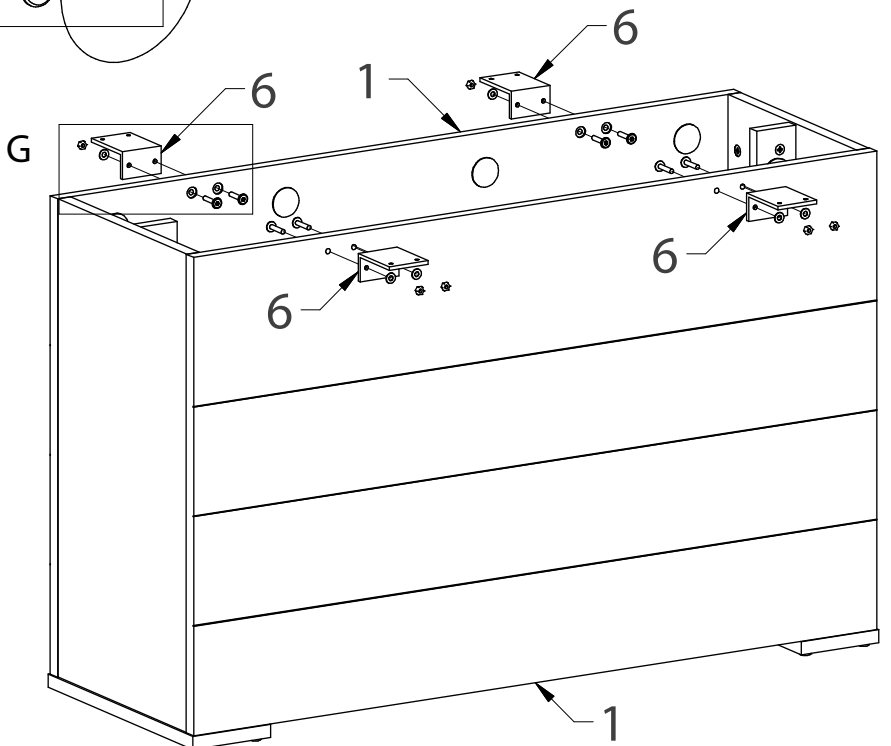
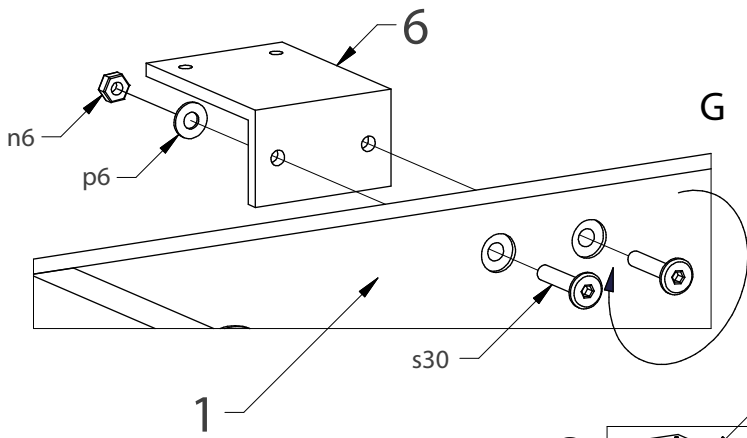
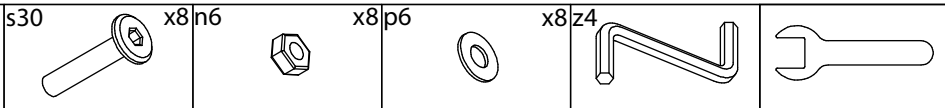

10

s15

x8n5

x8p5

x8z4

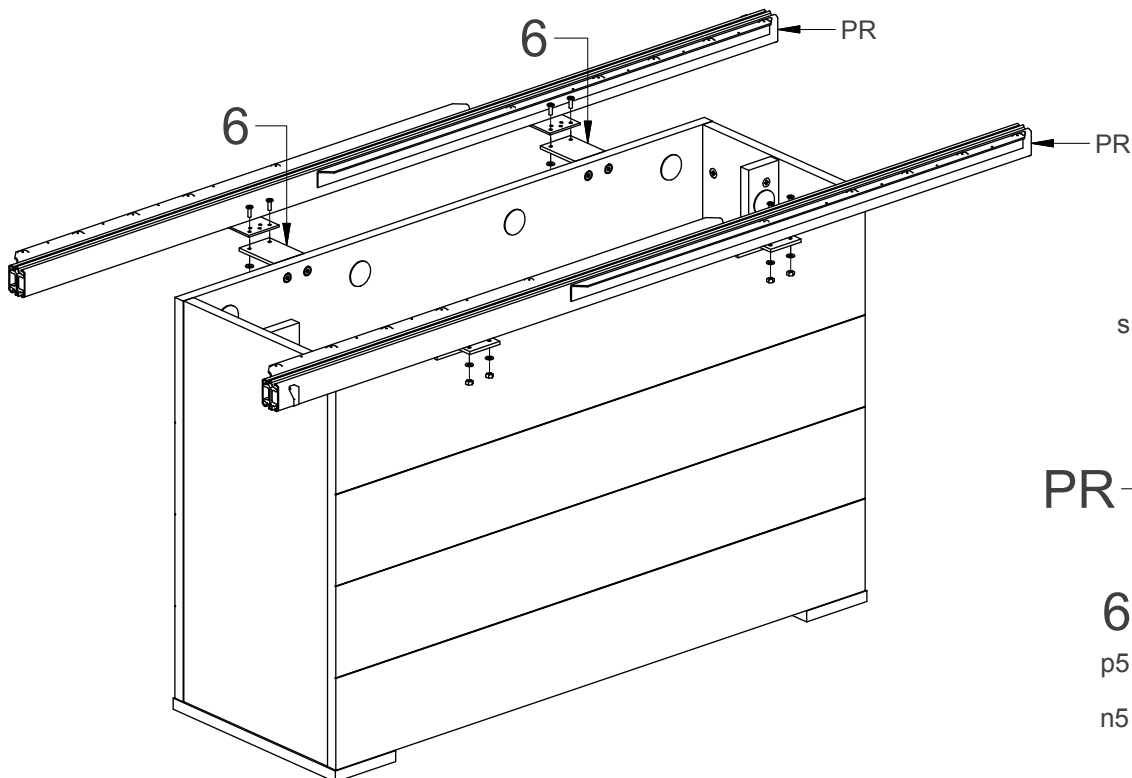
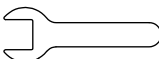

11

td

x14

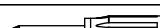

z x10 zz

x10 w16

x50

z x6 zz

x6 w16

x30

KOLOS

KOLOS 2

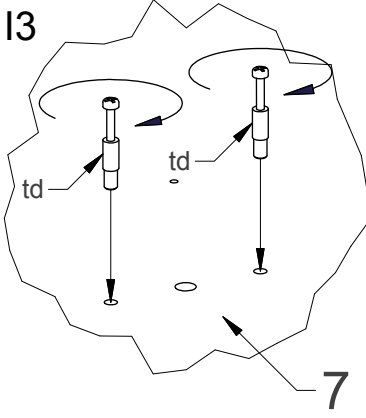
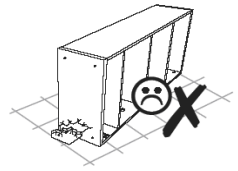
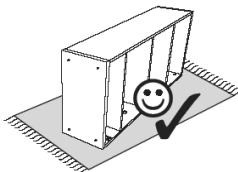
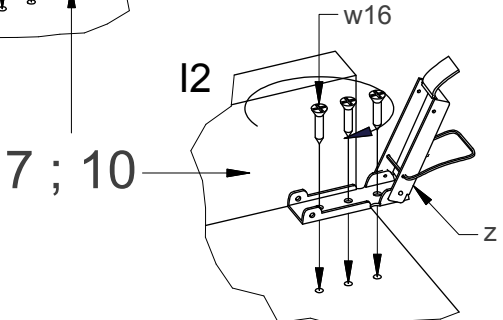
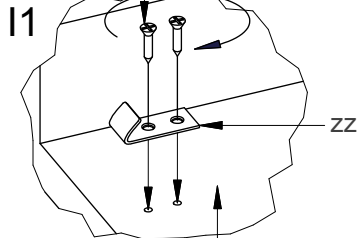
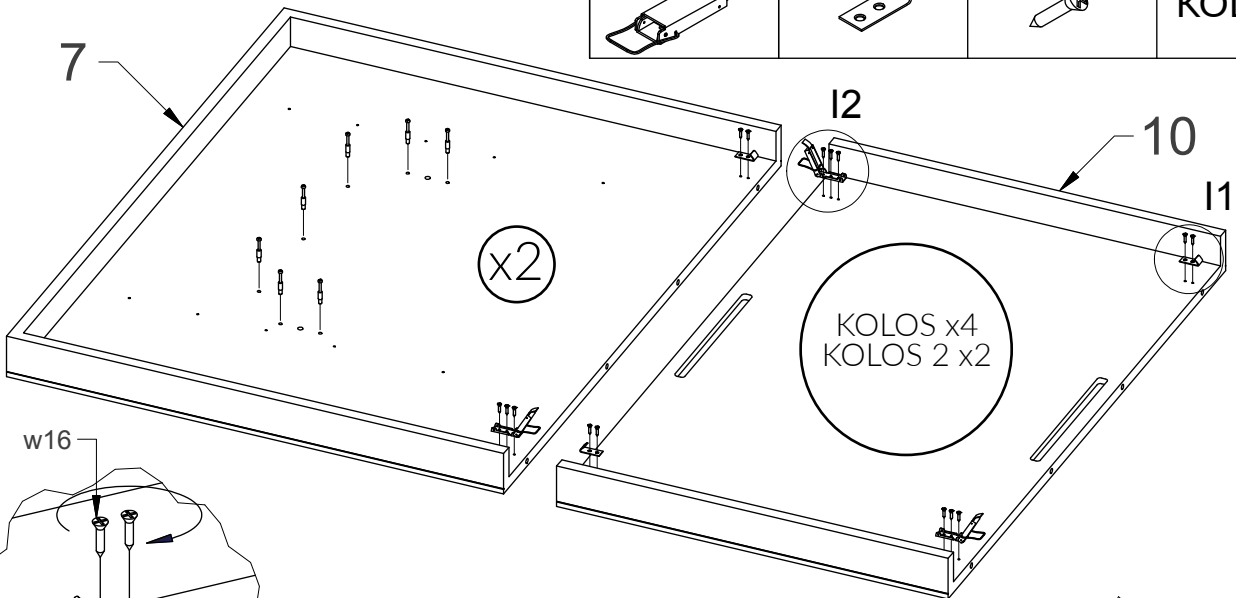

12

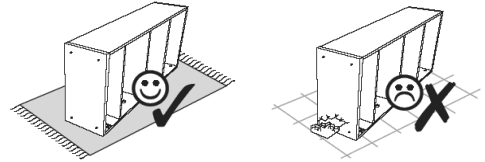
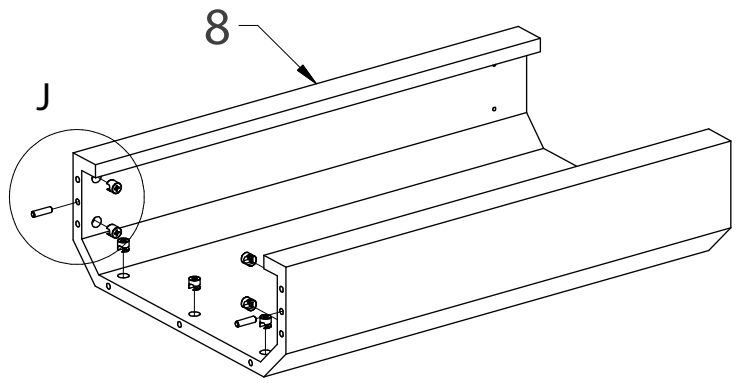
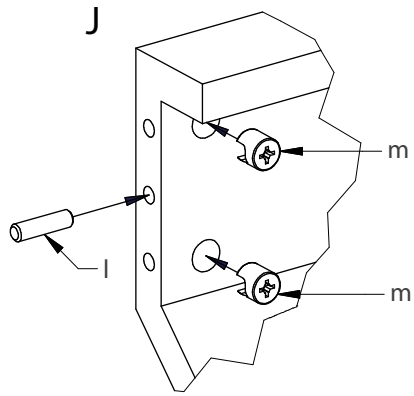
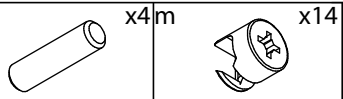

13

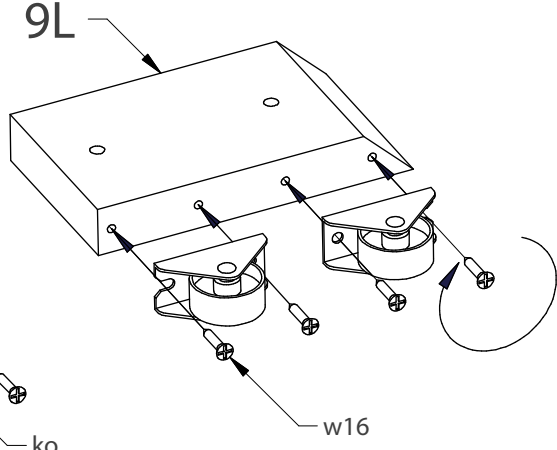
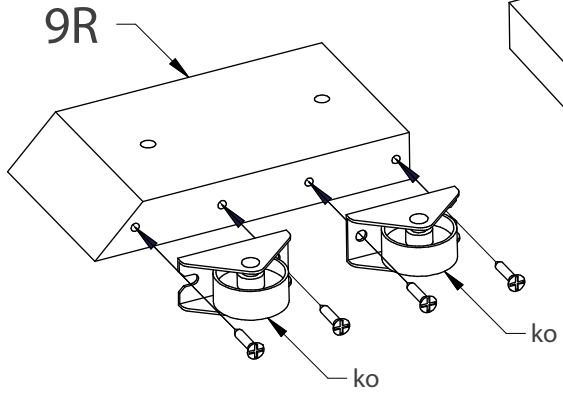
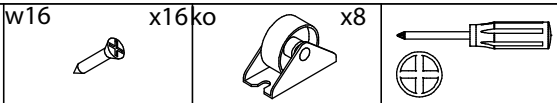

14

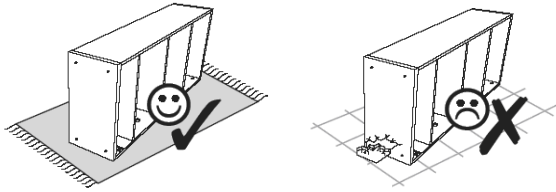
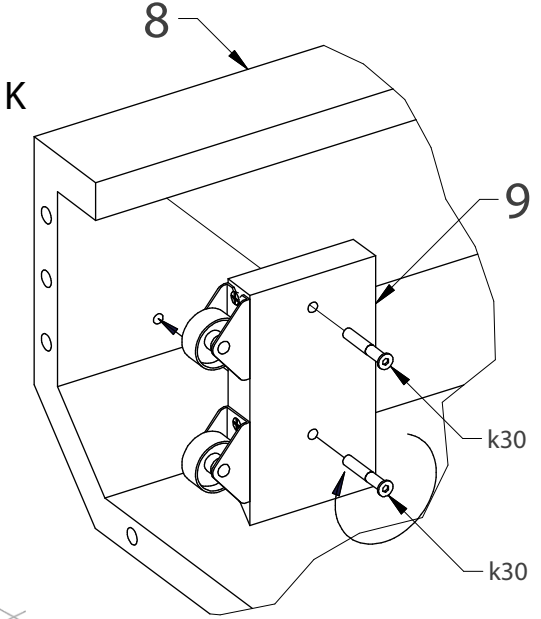
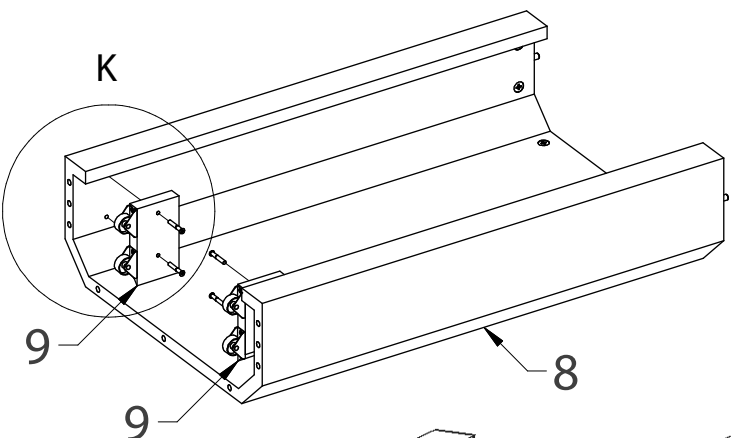
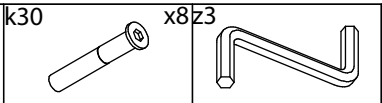

15

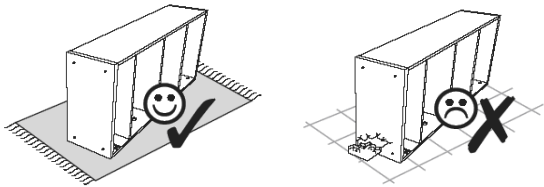
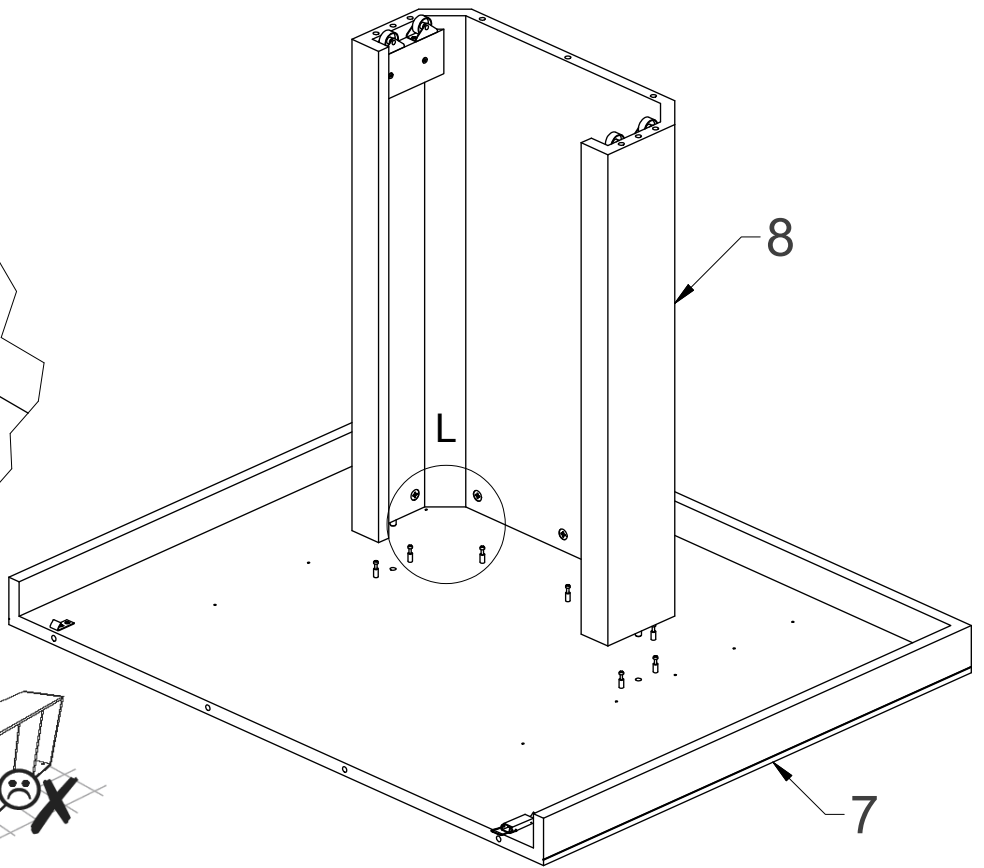
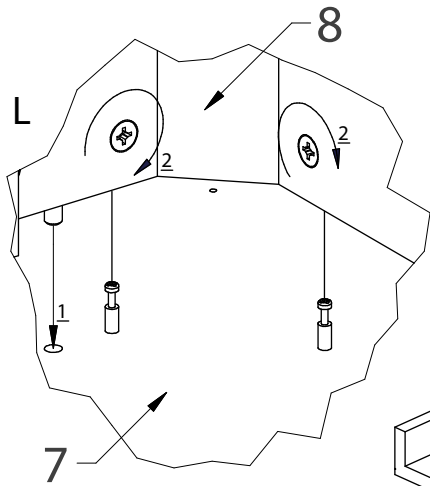
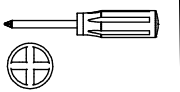

16

ew5

x20

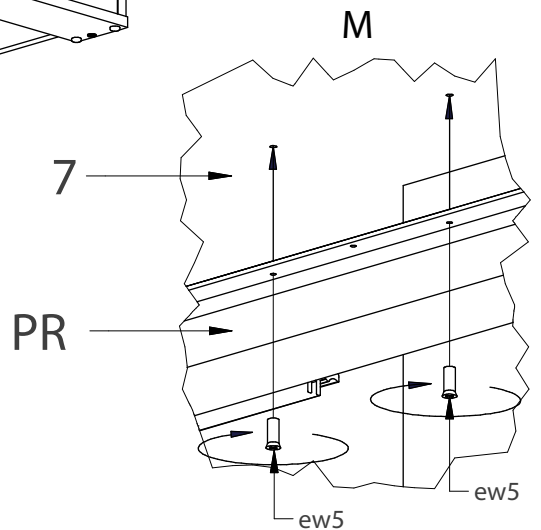
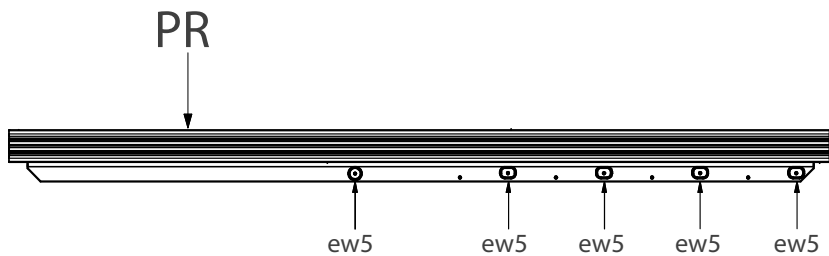
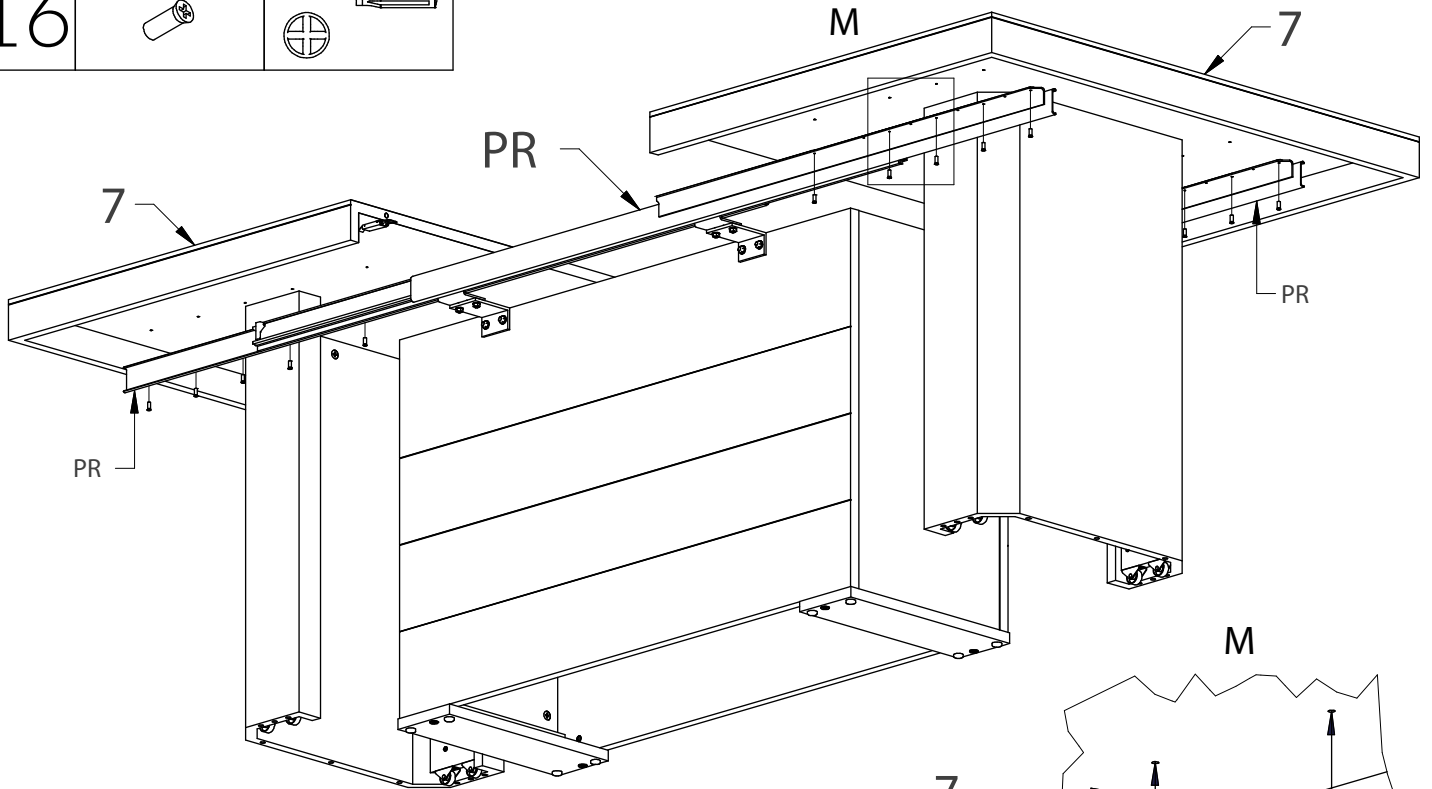
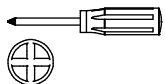

17

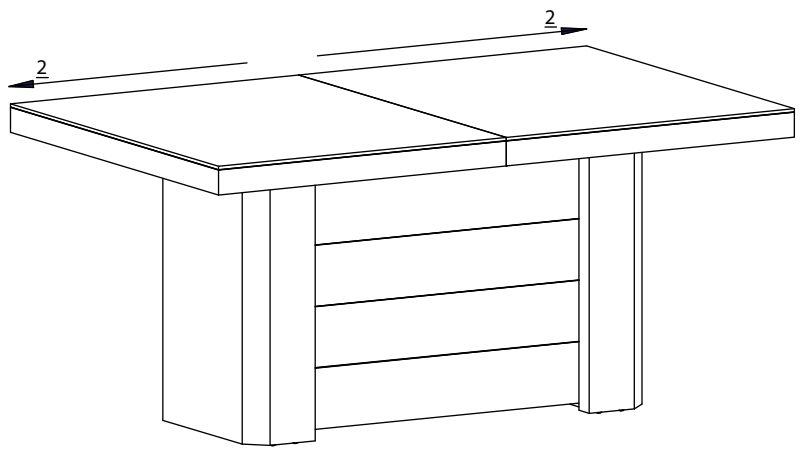
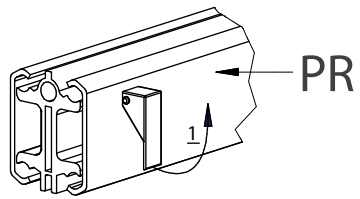

18

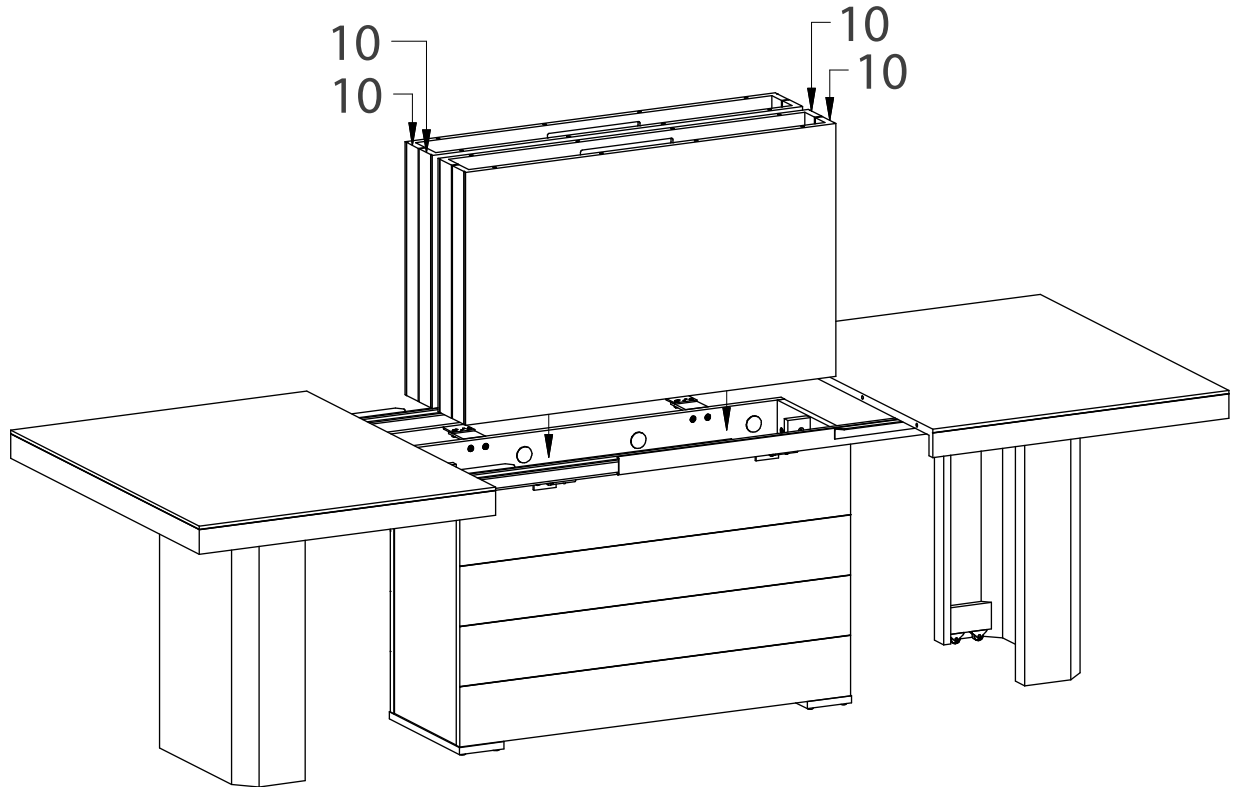

„KOLOS” - 10 - x4

„KOLOS 2” - 10 - x2

19

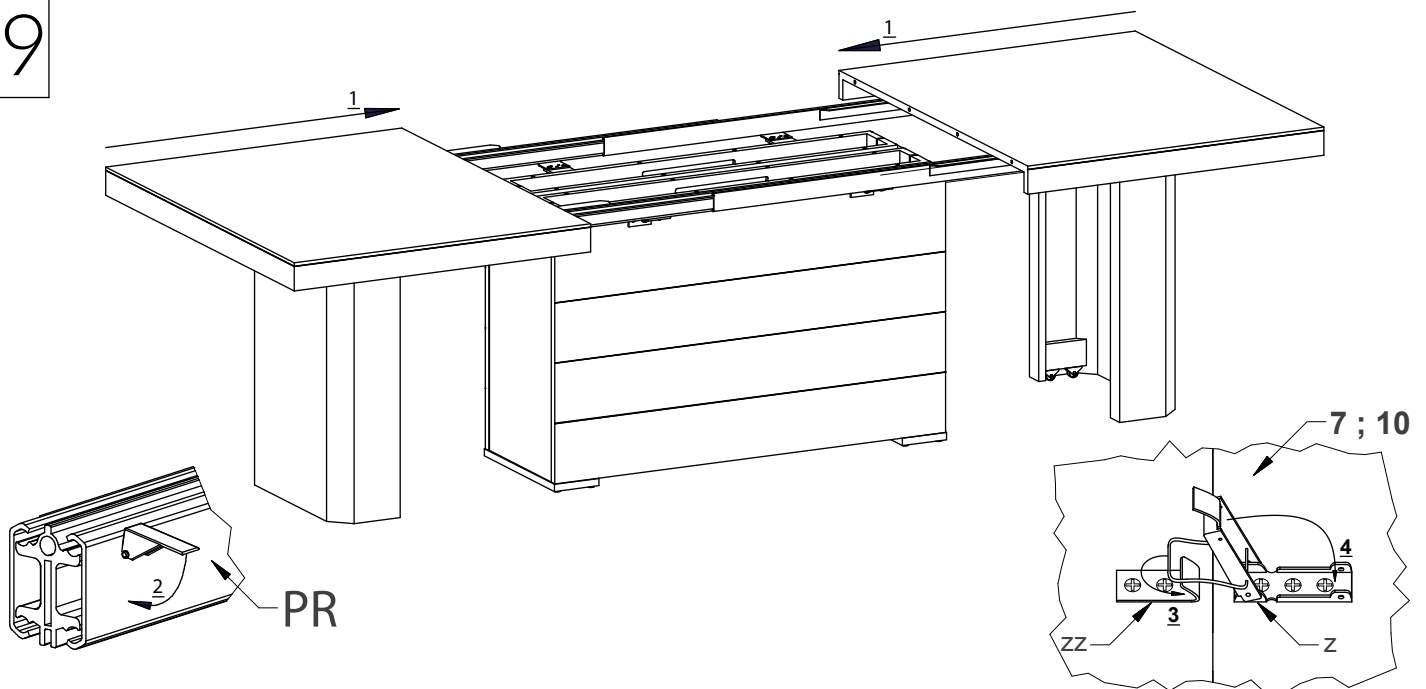

Zasady użytkowania / Terms of Use / Nutzungsbedingungen / Podmínky použití

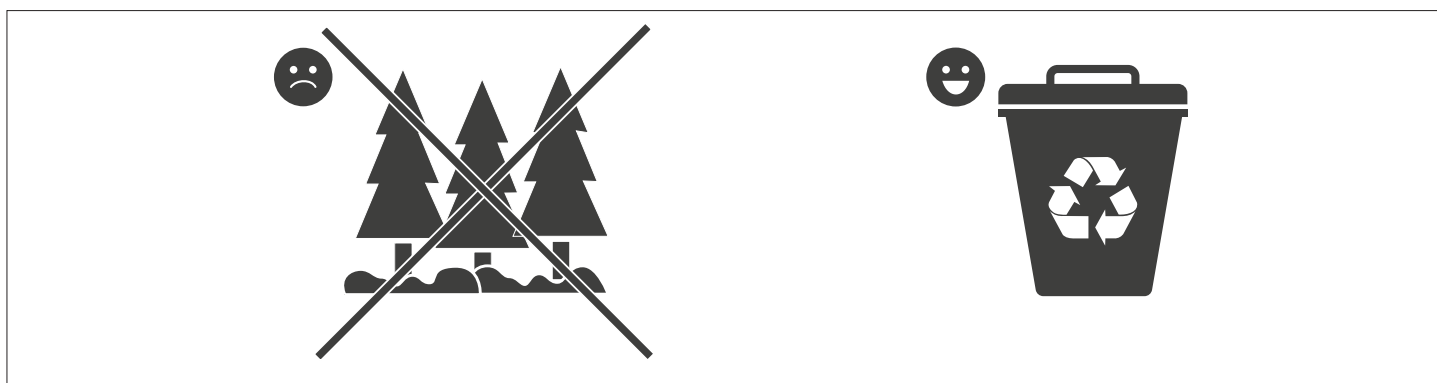
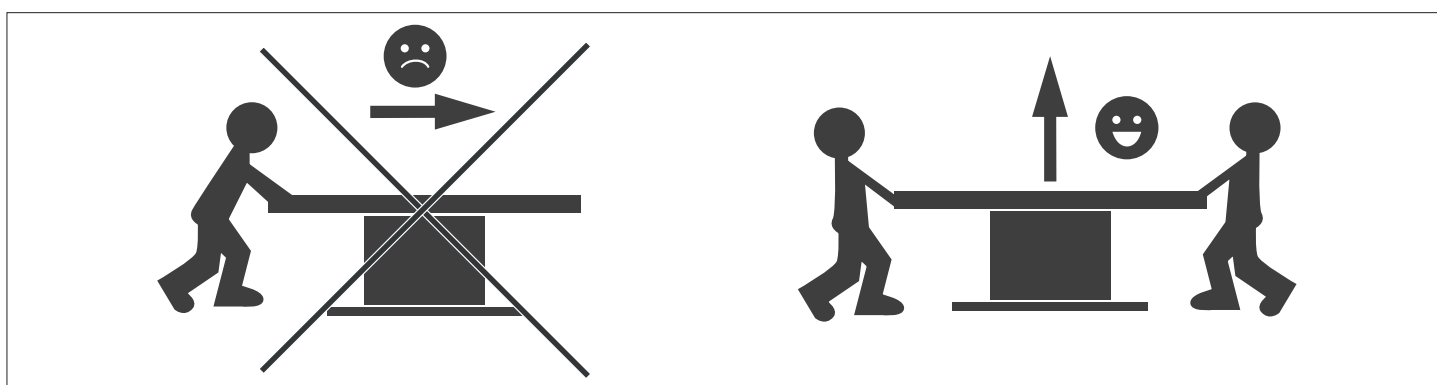
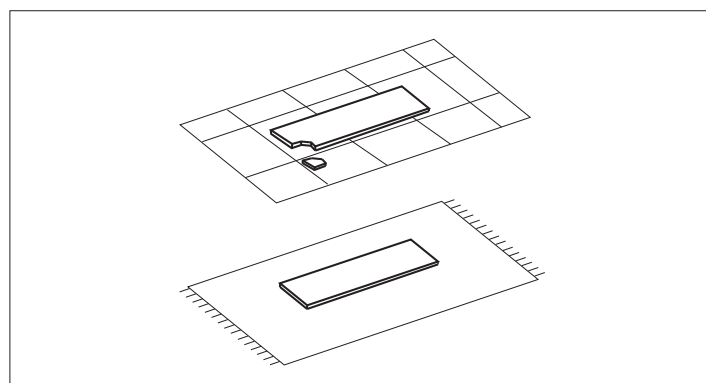
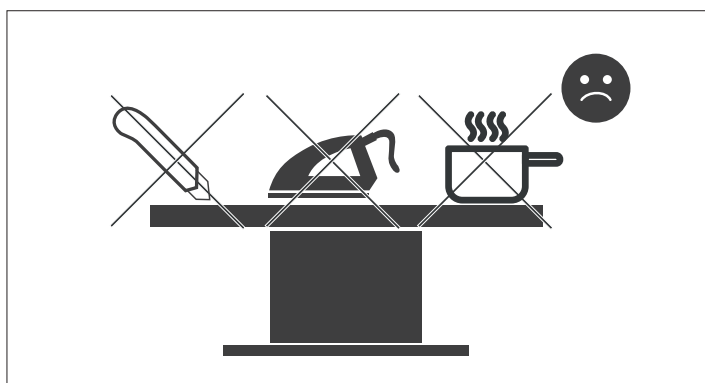
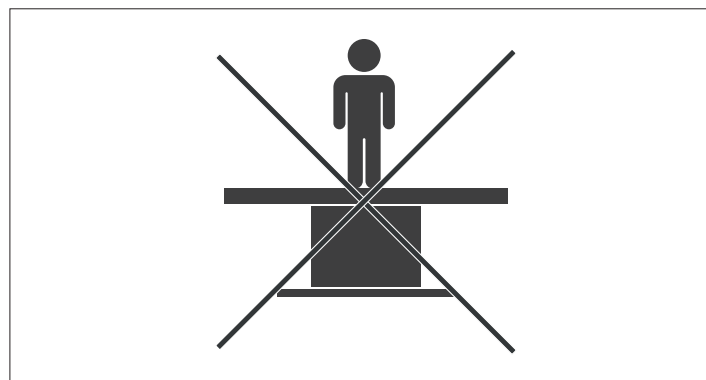
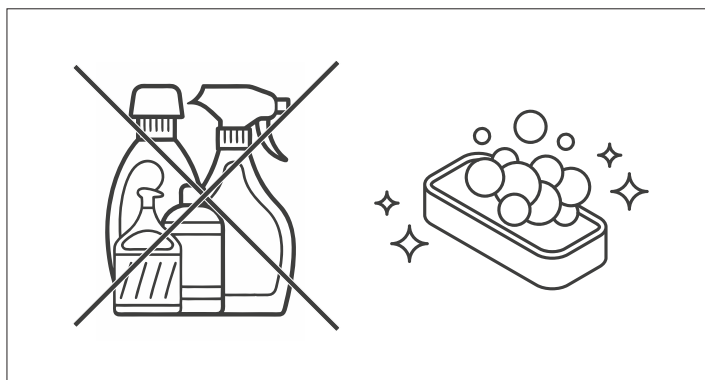
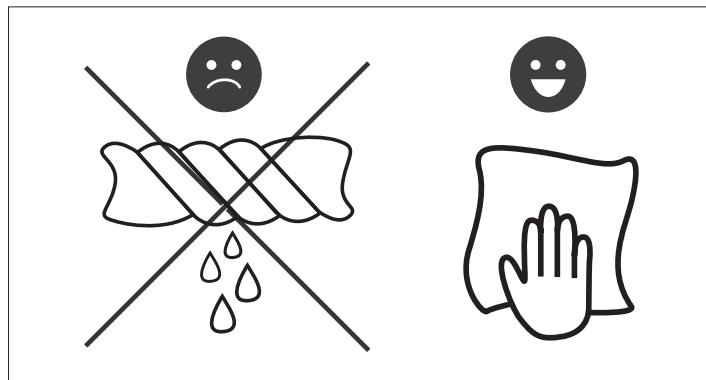
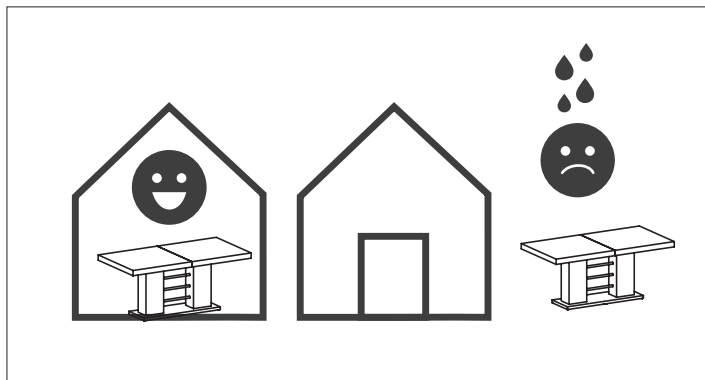

PL UWAGA!

Wszystkie elementy wykonane z płyty wysokopółyskowej są pokryte folią ochronną (przezroczystą lub niebieską), którą należy usunąć po zmontowaniu mebla.

GB Attention!

All elements made of high-gloss board (matt) are covered with a protective foil (transparent or blue), which should be removed after assembling the furniture.

DE Achtung!

Alle Elemente mit Hochglanzoberfläche (und matt) sind mit einer Schutzfolie (transparent oder blau) bedeckt, die nach dem Zusammenbau des Möbels entfernt werden sollte.

CZ UPOZORNĚNÍ!

Všechny díly vyrobené z desek MDF s povrchem vysoký lesk (mat), mají ochrannou folii na tomto povrchu. Folie je průhledná nebo světlemodrá. Po smontování nábytku, tyto folie odstraňte.

SK UPOZORNENIE!

Všetky časti vyrobené z vysokolesklej MDF dosky sú pokryté ochrannou fóliou /priesvitná alebo bledo modrá/, ktorú je potrebné stiahnuť po zmontovaní nábytku.

PL UWAGA!

Przed przystąpieniem do montażu mebla z miejsc połączeń elementów usunąć folię ochronną!
Dla zapewnienia długotrwałej satysfakcji z użytkowania i jakości wyrobu, zaleca się stosowanie podkładek pod naczynia z gorącą zawartością.

GB ATTENTION!

Prior to assembly, it is necessary to remove protective foil strictly from the connecting parts within this furniture piece.
To preserve surface quality of the furniture, it is recommended you use a mat to place your hot dishes on.

DE ACHTUNG!

Vor dem Montagebeginn die Schutzfolie an den Kanten der Einzelelemente ein wenig abziehen!
Um eine langfristige Zufriedenheit über die Produktqualität sicherzustellen, empfehlen wir die Verwendung einer Unterlage um die heißen Behälter abzuschildern.

CZ UPOZORNĚNÍ!

Před započítím montáže nábytku, v místech spojů nábytkových dílů, ochrannou folii odstraňte.
Spoje nábytku budou pevnější.
Pro zachování dlouhé kvality nábytku, doporučujeme při užívání pod teplé/horké nádoby používat podložky!

SK UPOZORNENIE!

Pred začatím montáže nábytku odstráňte ochrannú fóliu z miest, kde sa diely spájajú.
Pre dlhodobú spokojnosť s používaním a kvalitou výrobku je dôležité používať podložky pod riad s horúcim obsahom alebo riad s drsnou spodnou časťou.

www.hubertus-design.pl | kontakt@hubertus-design.pl

https://hubertus-design.pl/bezpieczenstwo_produkto/